



DOLIN[®]
品質. 服務. 創新



DONG LING[®]
QUALITY . SERVICE . INNOVATION



專業製造廠

小型齒輪減速、變速電機系列
PRECISION GEAR MOTOR SERIES



台灣東菱精密減速機有限公司

Taiwan Dong Ling M&E Technology Manufacture CO.,LTD





敬業，務實，團結，拼搏

Devoted Career、Pragmatic、United、Efforts

- 企業目標：做精、做強、做大
Business Objective: Refined, Strong, Large
- 經營理念：質量第一、服務真誠、不斷創新
Management Philosophy: First Quality, Sincere Service, Vnceasing Innovation
- 質量觀：質量是品牌的基石、品牌是企劃的生命
Values: Quality is foundation stone of brand, Brand is life of business
- 營銷理念：以市場為導向、以質量求生存、以信譽求發展
Marketing Philosophy: Market-Oriented, Living is in quality, Developing is in reputation



台灣東菱集團公司
TAIWAN DONG LING GROUP CO.LTD

專業製造廠

Professional manufacturing factory

企業簡介

Company Biography

- 1988 東菱機電台灣公司創立
DOLIN was established in Taiwan
- 2003 通過ISO9001:2000質量管理體系認證
Acquired ISO 9001:2000 Quality Management System Certificate
通過首批強制性產品 (CCC) 認證
Acquired CCC Certification
- 2004 首次推出高精度生產設備系列：分條機·複卷機·分切機·以及薄膜貼合機
Introduced new precision-machinery series: Slitting Machines, Rewinding Machines, Cutting Machines, and film Laminating Machines.
- 2011 東菱企業更趨壯大穩固，成為擁有超過200員工的中型企業
我們的產品市場遍佈整個中國大陸，台灣，以及東南亞等地區
DOLIN has developed steadily and become a medium-sized manufacturer with more than 200 professional employees
Our market has expanded all over mainland China, Taiwan area and other countries and regions in Southeast Asia
- 2012 東菱集團在越南平陽省設立分公司。越南東菱責任有限公司
Dolin Group established a branch in Vietnam, Binh Duong province. Dong Ling M&E Technology Manufacture CO.LTD
- 2016 東菱集團在越南河內成立分公司。河內分公司
Dolin Group established a branch in Vietnam, Ha Noi province. Branch in Hanoi
- 2021 東菱集團在越南海防成立分公司。海防分公司
Dolin Group established a branch in Vietnam, Hai Phong Province. Branch in Hai Phong

至今 東菱企業不斷致力於服務客戶，可信賴的產品品質已成為東菱不可抹滅的品牌形象並帶領我們的產品迎向全世界。
Currently DOLIN does not stop trying our best to serve customers. Our quality and reliability have strongly consolidated our brand reputation and brought our products to worldwide markets.

● 通過ISO9001:2000品質認證

ISO9001:2000 quality management system certification

● 通過國家強制性產品認證

"CCC" certification

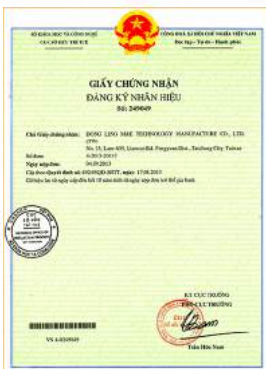
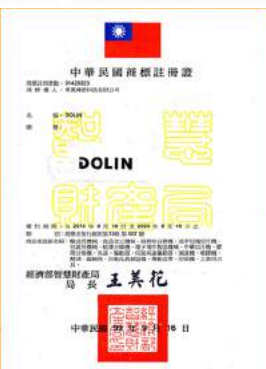

电机型号说明 Description of Motor Model

5	I	K	90	GU	—	C	F
型号尺寸 Model & Dimension	电机种类 Motor Type	电机系列 Motor Series	输出功率 Output Power	电机轴形状 Shape of Motor Shaft		电压极数 Supply & poles	其他附件 Other Accessory
2: 60mm 3: 70mm 4: 80mm 5: 90mm 6: 100mm	I: 感应电机 I: Induction Motor R: 可逆电机 R: Reversible Motor T: 力矩电机 T: Torque Motor	K 系列 K Series	6: 6W 15: 15W 25: 25W 40: 40W 60: 60W 90: 90W 120: 120W 140: 140W 180: 180W 200: 200W	A: 铣扁 A: Flat type A1: 铣键槽 A1: Milling Keyway GN: 普通型斜齿轴 GN: General Helical Gear GU: 加强型斜齿轴 GU: Reinforced Helical Gear		A: 单相 Single Phase 100~120V50Hz4P B: 单相 Single Phase 220~230V50Hz2P C: 单相 Single Phase 220~230V50Hz4P D: 单相 Single Phase 220~230V50Hz2P E: 单相 Single Phase 100~120V60Hz4P H: 单相 Single Phase 200~230V60Hz4P S: 三相 Three Phase 220~240V50Hz4P Ss: 三相 Three Phase 380~415V50Hz4P	F: 附风扇 F: W/ Fan FF: 附强制风扇 FF: W/ Forced Fan M: 附电磁刹车 M: W/ Electromagnetic Brake P: 附热保护器 P: W/ Overheat protector T: 附端子箱 T: W/ Terminal Box

- 注: 输出功率后加字母“R”表示调速电机。
- Note: The suffix “-R” after the output power means speed Adjustable Motor.

减速器型号说明 Description of Reducer Model

5	GU	50	K
型号尺寸 Model & Dimension	齿轮种类 Gear Type	减速比 Reduction Ratio	轴承种类 Bearing Type
2: 60mm 3: 70mm 4: 80mm 5: 90mm 6: 100mm	GN: 普通型斜齿轴 GN: General Helical Gear GU: 加强型斜齿轴 GU: Reinforced Helical Gear GS: 加强型带耳朵 GS: Reinforced Helical Gear with ear	50: 减速比为1:50 50: Reduction Ratio 1:50	K: 滚珠轴承 K: Ball Bearing B: 含油轴承 B: Grease Bearing

- 注: 非标准型分体式的编号为: 在电机型号或减速器型号前加“V”(请在定货时写明具体参数要求)。
- Note: The code of the non-standard split type is to add “V” before the model number of the motor or reducer (Please specify the detailed parameter requirement in the purchase order).

感应电机的一般规格 General specification of Induction motor

项目Items	内容contents
绝缘电阻 Insulation resistance	在常温、常湿度下, 运转电机后, 以DC 500V的绝缘电阻来测量电机的金属线圈和电机外壳之间的绝缘电阻时, 不超过100兆欧。 In the circumstance of normal temperature and humidity, the resistance can be up to 100MΩ, measured by DC 500V insulation resistance measurer between the motor wiring and motor shell while the motor is working.
绝缘电压 Insulation voltage	在常温、常湿度下, 运转电机后, 在电机的金属线圈和电机之间, 以1500V 50/60Hz输于1分钟时没有任何问题。 In the circumstance of normal temperature and humidity, there will be no problem supplying the power of 1500V 50/60Hz between the metal wiring and motor shell in 1minute while the motor is working.
温度上升 Temperature rise	运转电机后, 用电阻法来测量时, 线圈绕组温度的上升数值在80℃以下。(带风扇的绕组温度的上升数值在60℃以下) The temperature rise of wiring should be lower than 80 °C measured by resistance method when the motor is working. (the temperature of wiring with fan should be lower than 60 °C)
绝缘等级 Insulation class	B级(130 °C) (class B (130 °C))
使用温度 Using temperature	-10℃~+40℃ (三相: -10℃~+50℃)(无冰冻) -10 °C~+40 °C (Three phase -10 °C~+50 °C)(No freeze)
使用湿度 Using humidity	85%以下(没有结露的场所) ≤85% (Place without dew)

齿轮箱允许力矩说明 Description of Allowable Torque on Gearbox

- 减速器润滑方式为全封闭浸渍式润滑, 油脂不易干涸; ●齿轮箱型式中口, 表示减速比; ●减速器选用先进可靠的“一体式”减速器, 轴承室与减速壳体为一体, 采用全滚珠轴承; ●测试数据条件为同步转速下;
- 表格中的■(灰底部分)表示旋转方向与电机转向一致, 其它则与电机转向相反; ●输出轴转速不含电机转差率。根据负载大小不同, 转速要比上述数值低2~20%。
- The speed reducer is fully closed and immersion lubricated so that grease is not easy to dry. ●□In the type of gearbox indicates reduction ratio. ●A reliable state-of-the-art “integrated” speed reducer is used, which integrates bearing case and reducer case into one and full ball bearings are used. ●The gray color of the form indicates the same rotating direction of the motor while the rotating direction of others is opposite. ●The conditions of the testing data is under synchronous speed.
- The output shaft speed excludes the motor speed slip. The actual speed will be 2-20% lower than the above value depending upon the load.



外形尺寸 Overall Dimension

15W

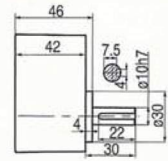
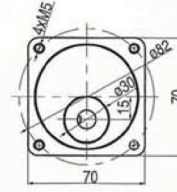
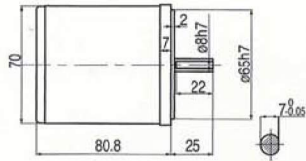

25W

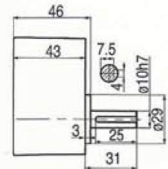
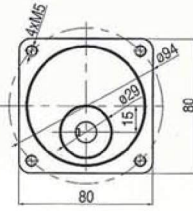

40W

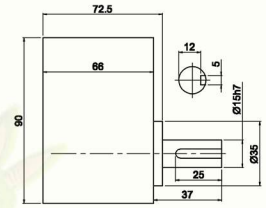
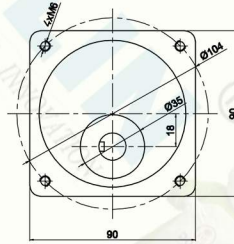
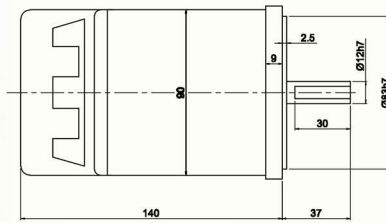

60W

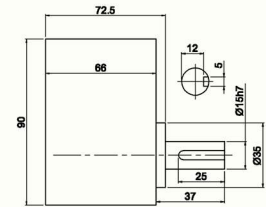
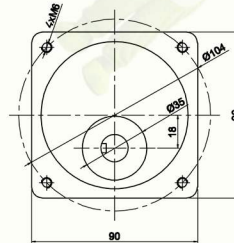
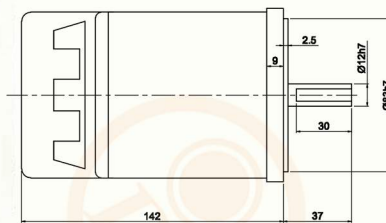

90W-120W

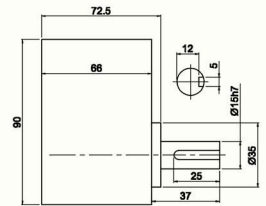
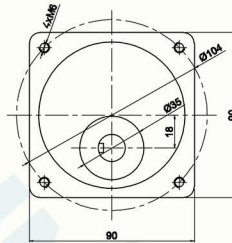
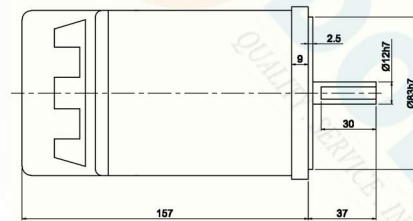

120W-200W

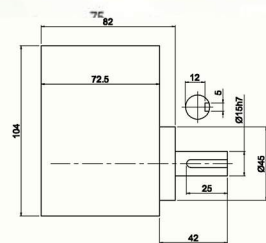
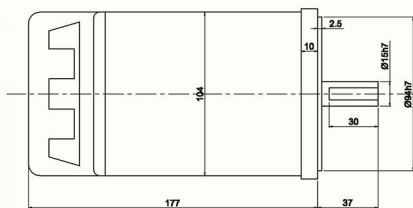



电机特性表 List of Motor Characteristics

型号/类型 Model / Type		额定功率 Rated Power	电压 Voltage	频率 Frequency	极数 Poles	额定转速 Rated Speed	启动转矩 Rated Torque	额定转矩 Rated Current	额定电流 Starting Torque	电容 Capacitor
光轴 Round shaft	齿轴 Pinion shaft	W	V	Hz	P	RPM	MN·M	MN·M	A	µf/450V
3IK15A-A	3IK15GN-A	15	1ph110	50/60	4	1300	0.09	0.11	0.30	6.0
3IK15A-C	3IK15GN-C	15	1ph220	50/60	4	1300	0.10	0.11	0.14	1.5
3IK15A-S	3IK15GN-S	15	3ph220	50/60	4	1300	0.12	0.13	0.16	/
4IK25A-A	4IK25GN-A	25	1ph110	50/60	4	1350	0.18	0.18	0.39	6.0
4IK25A-C	4IK25GN-C	25	1ph220	50/60	4	1350	0.18	0.18	0.22	2.0
4IK25A-S	4IK25GN-S	25	3ph220	50/60	4	1300	0.19	0.19	0.25	/
4IK25A-S ₃	4IK25GN-S ₃	25	3ph380	50/60	4	1300	0.19	0.19	0.14	/
5IK40A1-A	5IK40GN-A	40	1ph110	50/60	4	1350	0.25	0.29	0.64	10.0
5IK40A1-C	5IK40GN-C	40	1ph220	50/60	4	1350	0.28	0.29	0.29	2.5
5IK40A1-S	5IK40GN-S	40	3ph220	50/60	4	1300	1.15	0.29	0.38	/
5IK40A1-S ₃	5IK40GN-S ₃	40	3ph380	50/60	4	1300	1.15	0.29	0.22	/
5IK60A1-AF	5IK60GN-AF	60	1ph110	50/60	4	1350	0.38	0.44	0.98	12.0
5IK60A1-CF	5IK60GN-CF	60	1ph220	50/60	4	1350	0.40	0.44	0.43	3.5
5IK60A1-SF	5IK60GN-SF	60	3ph220	50/60	4	1350	1.70	0.46	0.49	/
5IK60A1-S ₃ F	5IK60GN-S ₃ F	60	3ph380	50/60	4	1350	1.70	0.46	0.28	/
5IK90A1-AF	5IK90GN-AF	90	1ph110	50/60	4	1350	0.50	0.64	1.40	18.0
5IK90A1-CF	5IK90GN-CF	90	1ph220	50/60	4	1350	0.48	0.64	0.59	5.0
5IK90A1-SF	5IK90GN-SF	90	3ph220	50/60	4	1300	2.40	0.66	0.66	/
5IK90A1-S ₃ F	5IK90GN-S ₃ F	90	3ph380	50/60	4	1300	2.40	0.66	0.28	/
5IK120A1-AF	5IK120GN-AF	120	1ph110	50/60	4	1250	0.65	0.9	1.80	18.0
5IK120A1-CF	5IK120GN-CF	120	1ph220	50/60	4	1300	0.75	0.87	0.82	6.5
5IK120A1-SF	5IK120GN-SF	120	3ph220	50/60	4	1300	3.20	0.87	0.83	/
5IK120A1-S ₃ F	5IK120GN-S ₃ F	120	3ph380	50/60	4	1300	3.20	0.87	0.40	/
5IK180A1-AF	5IK180GN-AF	180	1ph110	50/60	4	1250	0.97	1.27	2.40	30.0
5IK180A1-CF	5IK180GN-CF	180	1ph220	50/60	4	1300	1.12	1.23	1.21	12.0
5IK180A1-SF	5IK180GN-SF	180	3ph220	50/60	4	1300	4.50	1.23	0.83	/
5IK180A1-S ₃ F	5IK180GN-S ₃ F	180	3ph380	50/60	4	1300	4.50	1.23	0.59	/
6IK120A1-AF	6IK120GN-AF	120	1ph110	50/60	4	1350	0.59	0.85	1.90	30.0
6IK120A1-CF	6IK120GN-CF	120	1ph220	50/60	4	1350	0.75	0.85	0.86	8.0
6IK120A1-SF	6IK120GN-SF	120	3ph220	50/60	4	1350	3.50	0.85	0.89	/
6IK120A1-S ₃ F	6IK120GN-S ₃ F	120	3ph380	50/60	4	1350	3.50	0.85	0.51	/
6IK140A1-AF	6IK140GN-AF	140	1ph110	50/60	4	1350	0.90	0.99	2.00	30.0
6IK140A1-CF	6IK140GN-CF	140	1ph220	50/60	4	1350	0.90	0.99	0.91	8.0
6IK140A1-SF	6IK140GN-SF	140	3ph220	50/60	4	1350	3.50	0.99	0.95	/
6IK140A1-S ₃ F	6IK140GN-S ₃ F	140	3ph380	50/60	4	1350	3.50	0.99	0.55	/
6IK180A1-AF	6IK180GN-AF	180	1ph110	50/60	4	1350	1.20	1.25	2.30	30.0
6IK180A1-CF	6IK180GN-CF	180	1ph220	50/60	4	1350	1.20	1.25	1.17	10.0
6IK180A1-SF	6IK180GN-SF	180	3ph220	50/60	4	1350	4.60	1.25	0.95	/
6IK180A1-S ₃ F	6IK180GN-S ₃ F	180	3ph380	50/60	4	1350	4.60	1.25	0.55	/
6IK200A1-AF	6IK200GN-AF	200	1ph110	50/60	4	1350	1.30	1.32	2.50	30.0
6IK200A1-CF	6IK200GN-CF	200	1ph220	50/60	4	1350	1.30	1.32	1.23	10.0
6IK200A1-SF	6IK200GN-SF	200	3ph220	50/60	4	1350	4.60	1.32	0.95	/
6IK200A1-S ₃ F	6IK200GN-S ₃ F	200	3ph380	50/60	4	1350	4.60	1.32	0.55	/

●使用电压不同，电容容量也不相同。故应与使用电压相对应，正确使用。●不能正确使用是造成故障的主要原因。订货时，在确认使用电压后，选择正确的型号进行订货。
●The capacitor capacitance will be different under different voltage. A correct capacitor capacitance is required to match the applied voltage. ●Wrong capacitor capacitance is the cause of trouble. You must confirm a correct voltage and select a correct model when your purchase order is placed.

感應電機 Induction Motor

装有减速机时的容许转矩 allowable torque with gearbox

50Hz电机 单位: kgf.cm/N.m

转速Output Shaft Speed	500	417	300	250	200	166	150	120	100	83	75	60	50	41	37	30	25	20	16	15	12	10	8	7.5
减速比Reduction Ratio	3	3.6	5	6	7.5	9	10	12.5	15	18	20	25	30	36	40	50	60	75	90	100	120	150	180	200
3IK15GN-□ 3GN□K	3.2	3.9	5.4	6.5	8.1	9.7	10.8	13.5	16.2	19.4	19.4	24.2	29.1	34.9	38.8	43.6	50.0	50.0	50.0	50.0	50.0	50.0	50.0	50.0
	0.314	0.382	0.530	0.637	0.794	0.951	1.059	1.324	1.587	1.902	1.902	2.373	2.854	3.423	3.805	4.276	4.90	4.90	4.90	4.90	4.90	4.90	4.90	4.90
4IK25GN-□ 4GN□K	5.3	6.4	8.9	10.7	13.4	16.0	17.8	22.3	26.7	32.1	32.1	40.2	48.2	57.8	64.2	72.6	80.0	80.0	80.0	80.0	80.0	80.0	80.0	80.0
	0.519	0.627	0.872	1.049	1.313	1.568	1.744	2.185	2.617	3.146	3.146	3.940	4.724	5.664	6.292	7.115	7.84	7.84	7.84	7.84	7.84	7.84	7.84	7.84
5IK40GN-□ 5GN□K	8.3	9.9	13.8	16.5	20.7	24.8	27.5	34.4	41.3	49.6	62.1	74.5	89.4	99.3	100.0	100.0	100.0	100.0	100.0	100.0	100.0	100.0	100.0	100.0
	0.813	0.970	1.352	1.617	2.029	2.430	2.695	3.371	4.047	4.861	4.861	6.086	7.301	8.761	9.731	9.80	9.80	9.80	9.80	9.80	9.80	9.80	9.80	9.80
5IK60GN-□ 5GN□K	12.2	14.6	20.3	24.3	30.4	36.5	40.5	45.6	54.8	65.7	73.0	82.5	99.0	119.0	132.0	165.0	198.0	200.0	200.0	200.0	200.0	200.0	200.0	200.0
	1.196	1.431	1.989	2.381	2.989	3.577	3.969	4.469	5.370	6.439	7.154	8.085	9.702	11.66	12.94	16.17	19.40	19.60	19.60	19.60	19.60	19.60	19.60	19.60
5IK90GU-□ 5GU□K	18.2	21.9	30.4	36.5	45.6	54.7	60.8	68.4	82.1	98.6	110.0	124.0	149.0	178.0	198.0	200.0	200.0	200.0	200.0	200.0	200.0	200.0	200.0	200.0
	1.784	2.145	2.979	3.577	4.469	5.361	5.958	6.703	8.046	9.663	10.78	12.15	14.60	17.44	19.40	19.60	19.60	19.60	19.60	19.60	19.60	19.60	19.60	19.60
5IK120GU-□ 5GU□K	23.2	27.8	38.7	46.4	58.0	69.6	77.4	87.0	104.0	125.0	139.0	156.0	188.0	200.0	200.0	200.0	200.0	200.0	200.0	200.0	200.0	200.0	200.0	200.0
	2.276	2.731	3.793	4.552	5.689	6.827	7.586	8.534	10.24	12.29	13.65	15.36	18.43	19.61	19.61	19.61	19.61	19.61	19.61	19.61	19.61	19.61	19.61	19.61
5IK180GU-□ 5GU□K	34.0	41.0	57.0	68.0	85.1	102.0	113.0	128.0	153.0	184.0	204.0	230.0	278.0	300.0	300.0	300.0	300.0	300.0	300.0	300.0	300.0	300.0	300.0	300.0
	3.336	4.021	5.590	6.672	8.341	10.01	11.12	12.55	15.01	18.04	20.02	22.56	27.26	29.42	29.42	29.42	29.42	29.42	29.42	29.42	29.42	29.42	29.42	29.42
6IK120GU-□ 6GU□K	21.0	25.3	35.1	42.1	52.6	63.2	63.2	79.1	94.9	114.0	114.0	143.0	171.0	206.0	228.0	286.0	343.0	400.0	400.0	400.0	400.0	400.0	400.0	400.0
	2.06	2.48	3.44	4.13	5.16	6.19	6.19	7.75	9.30	11.20	11.20	14.00	16.80	20.00	22.40	28.00	33.60	39.20	39.20	39.20	39.20	39.20	39.20	39.20
6IK140GU-□ 6GU□K	24.1	28.8	40.1	48.1	60.1	72.1	72.1	90.3	108.0	130.0	130.0	163.0	196.0	235.0	261.0	327.0	392.0	400.0	400.0	400.0	400.0	400.0	400.0	400.0
	2.36	2.83	3.93	4.71	5.89	7.07	7.07	8.85	10.60	12.70	12.70	16.00	19.20	23.00	25.60	32.00	38.40	39.20	39.20	39.20	39.20	39.20	39.20	39.20
6IK180GU-□ 6GU□K	24.1	28.8	40.1	48.1	60.1	72.1	72.1	90.3	108.0	130.0	130.0	163.0	196.0	235.0	261.0	327.0	392.0	400.0	400.0	400.0	400.0	400.0	400.0	400.0
	2.36	2.83	3.93	4.71	5.89	7.07	7.07	8.85	10.60	12.70	12.70	16.00	19.20	23.00	25.60	32.00	38.40	39.20	39.20	39.20	39.20	39.20	39.20	39.20
6IK200GU-□ 6GU□K	24.1	28.8	40.1	48.1	60.1	72.1	72.1	90.3	108.0	130.0	130.0	163.0	196.0	235.0	261.0	327.0	392.0	400.0	400.0	400.0	400.0	400.0	400.0	400.0
	2.36	2.83	3.93	4.71	5.89	7.07	7.07	8.85	10.60	12.70	12.70	16.00	19.20	23.00	25.60	32.00	38.40	39.20	39.20	39.20	39.20	39.20	39.20	39.20

60Hz电机 单位: kgf.cm/N.m

转速Output Shaft Speed	600	500	360	300	240	200	180	144	120	100	90	72	60	50	45	36	30	24	20	18	15	12	10	9
减速比Reduction Ratio	3	3.6	5	6	7.5	9	10	12.5	15	18	20	25	30	36	40	50	60	75	90	100	120	150	180	200
3IK15GN-□ 3GN□K	3.0	3.6	5.1	6.1	7.6	9.1	10.1	12.7	15.2	18.2	18.2	22.8	27.3	32.8	36.5	41.0	49.2	50.0	50.0	50.0	50.0	50.0	50.0	50.0
	0.294	0.353	0.500	0.598	0.745	0.892	0.990	1.245	1.491	1.785	1.785	2.236	2.677	3.217	3.579	4.021	4.825	4.90	4.90	4.90	4.90	4.90	4.90	4.90
4IK25GN-□ 4GN□K	4.4	5.2	7.3	8.7	10.9	13.1	14.6	18.2	21.9	26.2	26.3	32.9	39.4	47.3	52.6	59.4	71.3	80.0	80.0	80.0	80.0	80.0	80.0	80.0
	0.431	0.510	0.715	0.853	1.068	1.284	1.431	1.784	2.146	2.568	2.577	3.224	3.861	4.635	5.155	5.821	6.987	7.84	7.84	7.84	7.84	7.84	7.84	7.84
5IK40GN-□ 5GN□K	6.8	8.2	11.3	13.6	17.0	20.4	22.7	28.4	34.0	40.8	40.9	51.1	61.3	73.6	81.8	100.0	100.0	100.0	100.0	100.0	100.0	100.0	100.0	100.0
	0.666	0.804	1.107	1.333	1.666	1.999	2.225	2.783	3.332	3.998	4.008	5.008	6.007	7.213	8.016	9.800	9.800	9.800	9.800	9.800	9.800	9.800	9.800	9.800
5IK60GN-□ 5GN□K	9.7	11.7	16.2	19.4	24.3	29.2	32.4	36.5	43.8	52.6	58.4	66.0	79.2	95.0	106.0	132.0	158.0	177.0	200.0	200.0	200.0	200.0	200.0	200.0
	0.953	1.147	1.588	1.901	2.381	2.862	3.175	3.577	4.292	5.155	5.726	6.648	7.762	9.31	10.39	12.94	15.48	17.35	19.60	19.60	19.60	19.60	19.60	19.60
5IK90GU-□ 5GU□K	14.6	17.5	24.3	29.2	36.5	43.7	48.6	54.8	65.7	78.8	87.6	99.0	119.0	143.0	158.0	198.0	200.0	200.0	200.0	200.0	200.0	200.0	200.0	200.0
	1.431	1.715	2.381	2.862	3.577	4.675	4.763	5.370	6.439	7.722	8.585	9.702	11.66	14.01	15.48	19.40	19.60	19.60	19.60	19.60	19.60	19.60	19.60	19.60
5IK120GU-□ 5GU□K	18.7	22.5	31.2	37.4	46.8	56.1	62.4	70.2	84.2	101.0	112.0	126.0	152.0	182.0	200.0	200.0	200.0	200.0	200.0	200.0	200.0	200.0	200.0	200.0
	1.835	2.202	3.058	3.670	4.587	5.505	6.116	6.881	8.257	9.909	11.01	12.39	14.86	17.84	19.61	19.61	19.61	19.61	19.61	19.61	19.61	19.61	19.61	19.61
5IK180GU-□ 5GU□K	28.1	34.0	47.0	57.0	71.0	84.2	94.0	105.0	126.0	152.0	168.0	189.0	227.0	273.0	300.0	300.0	300.0	300.0	300.0	300.0	300.0	300.0	300.0	300.0
	2.756	3.334	4.609	5.590	6.963	8.257	9.218	10.30	12.39	14.91	16.51	18.58	22.29	26.75	29.42	29.42	29.42	29.42	29.42	29.42	29.42	29.42	29.42	29.42
6IK120GU-□ 6GU□K	17.8	21.3	29.6	35.5	44.4	53.3	53.3	69.7	80.0	96.1	96.1	121.0	146.0	174.0	193.0	241.0	289.0	362.0	400.0	400.0	400.0	400.0	400.0	400.0
	1.74	2.09	2.90	3.48	4.35	5.22	5.22	6.54	7.85	9.42	9.42	11.80	14.20	17.00	18.90	23.60	28.40	35.50	39.20	39.20	39.20	39.20	39.20	39.20
6IK140GU-□ 6GU□K	20.7	24.9	34.6	41.2	51.8	62.1	62.1	77.6	93.4	112.0	112.0	141.0	169.0	203.0	226.0	282.0	338.0	400.0	400.0	400.0	400.0	400.0	400.0	400.0
	2.03	2.44	3.39	4.06	5.08	6.09	6.09	7.60	9.15	11.00	11.00	13.80	16.60	19.90	22.10	27.60	33.10	39.20	39.20	39.20	39.20	39.20	39.20	39.20
6IK180GU-□ 6GU□K	20.7	24.9	34.6	41.2	51.8	62.1	62.1	77.6	93.4	112.0	112.0	141.0	169.0	203.0	226.0	282.0	338.0	400.0	400.0	400.0	400.0	400.0	400.0	400.0
	2.03	2.44	3.39	4.06	5.08	6.09	6.09	7.60	9.15	11.00	11.00	13.80	16.60	19.90	22.10	27.60	33.10	39.20	39.20	39.20	39.20	39.20	39.20	39.20
6IK200GU-□ 6GU□K	20.7	24.9	34.6	41.2	51.8	62.1	62.1	77.6	93.4	112.0	112.0	141.0	203.0	226.0	282.0	338.0	400.0	400.0	400.0	400.0	400.0	400.0	400.0	400.0
	2.03	2.44	3.39	4.06	5.08	6.09	6.09	7.60	9.15	11.00	11.00	13.80	16.60	19.90	22.10	27.60	33.10	39.20	39.20	39.20	39.20	39.20	39.20	39.20



感应电机 · 2极 · 高速型电机特性表 Induction Motors 2-Poles · High Speed List of Motor Characteristics

型号/类型 Model / Type		额定功率 Rated Power	电压 Voltage	频率 Frequency	极数 Poles	额定转速 Rated Speed	启动转矩 Rated Torque	额定转矩 Rated Current	额定电流 Starting Torque	电容 Capacitor
光轴 Round shaft	齿轴 Pinion shaft	W	V	Hz	P	RPM	MN·M	MN·M	A	μf/450V
3IK15A-B	3IK15GN-B	15	1ph110	50/60	2	2800	0.07	0.05	0.36	6
3IK15A-D	3IK15GN-D	15	1ph220	50/60	2	3100	0.08	0.06	0.17	1.5
4IK25A-B	4IK25GN-B	25	1ph110	50/60	2	2800	0.09	0.09	0.65	10
4IK25A-D	4IK25GN-D	25	1ph220	50/60	2	3100	0.09	0.09	0.27	2.5
5IK40A1-B	5IK40GN-B	40	1ph110	50/60	2	2800	0.12	0.14	0.8	12
5IK40A1-D	5IK40GN-D	40	1ph220	50/60	2	3200	0.13	0.15	0.34	3
5IK60A1-BF	5IK60GN-BF	60	1ph110	50/60	2	2800	0.17	0.21	1.05	15
5IK60A1-DF	5IK60GN-D	60	1ph220	50/60	2	3200	0.25	0.21	0.56	3.5
5IK90A1-BF	5IK90GU-BF	90	1ph110	50/60	2	2800	0.28	0.34	1.44	25
5IK90A1-DF	5IK90GU-DF	90	1ph220	50/60	2	3200	0.34	0.3	0.79	6
5IK120A1-BF	5IK120GU-BF	120	1ph110	50/60	2	2800	0.33	0.45	2.25	30
5IK120A1-DF	5IK120GU-DF	120	1ph220	50/60	2	3200	0.51	0.4	1.2	8

●使用电压不同, 电容容量也不相同。故应与使用电压相对应, 正确使用。●不能正确使用是造成故障的主要原因。订货时, 在确认使用电压后, 选择正确的型号进行订货。
 ●The capacitor capacitance will be different under different voltage. A correct capacitor capacitance is required to match the applied voltage. ●Wrong capacitor capacitance is the cause of trouble. You must confirm a correct voltage and select a correct model when your purchase order is placed.



感應電機 · 2極 · 高速型 Induction Motor 2-Poles · High Speed

外形尺寸 Overall Dimension

15W

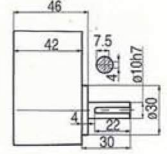
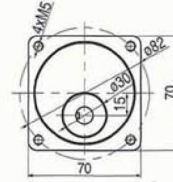

25W

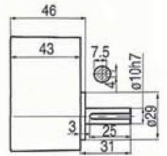
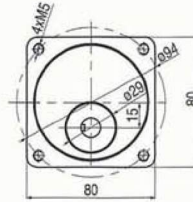

40W

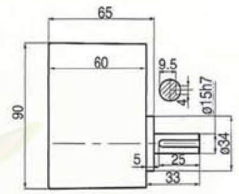
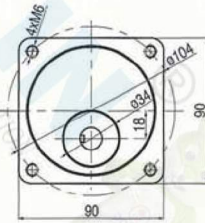
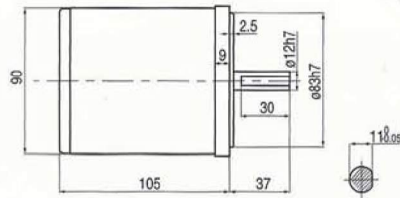

60W

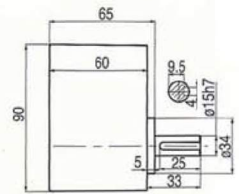
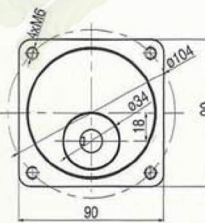
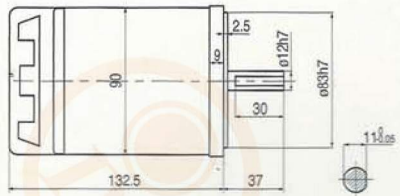

90W-120W

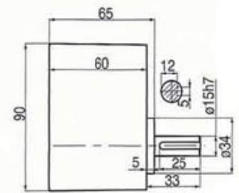
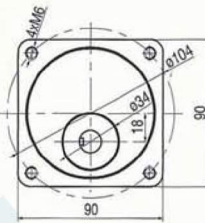
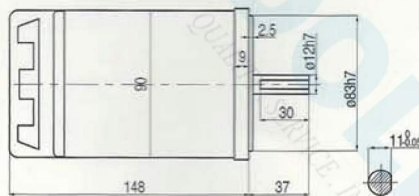

可逆變 Reversible Motor

电机特性表 List of Motor Characteristics

型号/类型 Model / Type		额定功率 Rated Power	电压 Voltage	频率 Frequency	极数 Poles	额定转速 Rated Speed	启动转矩 Rated Torque	额定转矩 Rated Current	额定电流 Starting Torque	电容 Capacitor
光轴 Round shaft	齿轴 Pinion shaft	W	V	Hz	P	RPM	MN-M	MN-M	A	μf/450V
3RK15A-A	3RK15GN-A	15	1ph110	50/60	4	1300	0.12	0.11	0.32	6.0
3RK15A-C	3RK15GN-C	15	1ph220	50/60	4	1300	0.12	0.11	0.17	1.5
4RK25A-A	4RK25GN-A	25	1ph110	50/60	4	1350	0.17	0.18	0.42	6.0
4RK25A-C	4RK25GN-C	25	1ph220	50/60	4	1350	0.20	0.18	0.28	2.0
5RK40A1-A	5RK40GN-A	40	1ph110	50/60	4	1350	0.30	0.29	0.68	12.0
5RK40A1-C	5RK40GN-C	40	1ph220	50/60	4	1350	0.30	0.29	0.35	3.0
5RK60A1-AF	5RK60GN-AF	60	1ph110	50/60	4	1350	0.45	0.44	1.10	12.0
5RK60A1-CF	5RK60GN-CF	60	1ph220	50/60	4	1350	0.45	0.44	0.46	3.5
5RK90A1-AF	5RK90GU-AF	90	1ph110	50/60	4	1350	0.48	0.64	1.55	18.0
5RK90A1-CF	5RK90GU-CF	90	1ph220	50/60	4	1350	0.61	0.64	0.65	5.0
5RK120A1-AF	5RK120GU-AF	120	1ph110	50/60	4	1250	0.78	0.90	2.10	18.0
5RK120A1-CF	5RK120GU-CF	120	1ph220	50/60	4	1300	0.85	0.87	1.10	6.5

●使用电压不同，电容容量也不相同。故应和使用电压相对应，正确使用。●不能正确使用是造成故障的主要原因。订货时，在确认使用电压后，选择正确的型号进行订货。
●The capacitor capacitance will be different under different voltage. A correct capacitor capacitance is required to match the applied voltage. ●Wrong capacitor capacitance is the cause of trouble. You must confirm a correct voltage and select a correct model when your purchase order is placed.

装有减速机时的容许转矩 allowable torque with gearbox

50Hz电机 单位: kgf.cm/N.m

转速Output Shaft Speed	500	417	300	250	200	166	150	120	100	83	75	60	50	41	37	30	25	20	16	15	12	10	8	7.5
减速比Reduction Ratio	3	3.6	5	6	7.5	9	10	12.5	15	18	20	25	30	36	40	50	60	75	90	100	120	150	180	200
3RK15GN-□ 3GN□	3.2	3.9	5.4	6.5	8.1	9.7	10.8	13.5	16.2	19.4	19.4	24.2	29.1	34.9	38.8	43.6	50.0	50.0	50.0	50.0	50.0	50.0	50.0	50.0
4RK25GN-□ 4GN□	5.3	6.4	8.9	10.7	13.4	16.0	17.8	22.3	26.7	32.1	32.1	40.2	48.2	57.8	64.2	72.6	80.0	80.0	80.0	80.0	80.0	80.0	80.0	80.0
5RK40GN-□ 5GN□	8.3	9.9	13.8	16.5	20.7	24.8	27.5	34.4	41.3	49.6	62.1	74.5	89.4	99.3	100.0	100.0	100.0	100.0	100.0	100.0	100.0	100.0	100.0	100.0
5RK60GN-□ 5GN□	12.2	14.6	20.3	24.3	30.4	36.5	40.5	45.6	54.8	65.7	73.0	82.5	99.0	119.0	132.0	165.0	198.0	200.0	200.0	200.0	200.0	200.0	200.0	200.0
5RK90GU-□ 5GU□	18.2	21.9	30.4	36.5	45.6	54.7	60.8	68.4	82.1	98.6	110.0	124.0	149.0	178.0	198.0	200.0	200.0	200.0	200.0	200.0	200.0	200.0	200.0	200.0
5RK120GU-□ 5GU□	23.2	27.8	38.7	46.4	58.0	69.6	77.4	87.0	104.0	125.0	139.0	156.0	188.0	200.0	200.0	200.0	200.0	200.0	200.0	200.0	200.0	200.0	200.0	200.0

60Hz电机 单位: kgf.cm/N.m

转速Output Shaft Speed	600	500	360	300	240	200	180	144	120	100	90	72	60	50	45	36	30	24	20	18	15	12	10	9
减速比Reduction Ratio	3	3.6	5	6	7.5	9	10	12.5	15	18	20	25	30	36	40	50	60	75	90	100	120	150	180	200
3RK15GN-□ 3GN□	3.0	3.6	5.1	6.1	7.6	9.1	10.1	12.7	15.2	18.2	18.2	22.8	27.3	32.8	36.5	41.0	49.2	50.0	50.0	50.0	50.0	50.0	50.0	50.0
4RK25GN-□ 4GN□	4.4	5.2	7.3	8.7	10.9	13.1	14.6	18.2	21.9	26.2	26.3	32.9	39.4	47.3	52.6	59.4	71.3	80.0	80.0	80.0	80.0	80.0	80.0	80.0
5RK40GN-□ 5GN□	6.8	8.2	11.3	13.6	17.0	20.4	22.7	28.4	34.0	40.8	40.9	51.1	61.3	73.6	81.8	100.0	100.0	100.0	100.0	100.0	100.0	100.0	100.0	100.0
5RK60GN-□ 5GN□	9.7	11.7	16.2	19.4	24.3	29.2	32.4	36.5	43.8	52.6	58.4	66.0	79.2	95.0	106.0	132.0	158.0	177.0	200.0	200.0	200.0	200.0	200.0	200.0
5RK90GU-□ 5GU□	14.6	17.5	24.3	29.2	36.5	43.7	48.6	54.8	65.7	78.8	87.6	99.0	119.0	143.0	158.0	198.0	200.0	200.0	200.0	200.0	200.0	200.0	200.0	200.0
5RK120GU-□ 5GU□	18.7	22.5	31.2	37.4	46.8	56.1	62.4	70.2	84.2	101.0	112.0	126.0	152.0	182.0	200.0	200.0	200.0	200.0	200.0	200.0	200.0	200.0	200.0	200.0

可反转 Reversible Motor



外形尺寸 Overall Dimension

15W

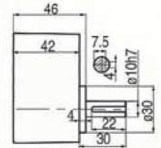
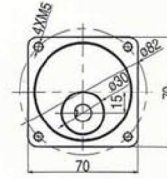
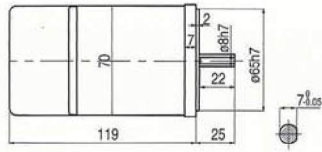

25W

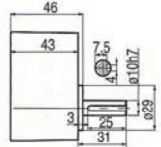
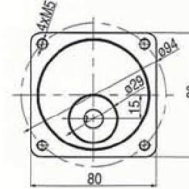
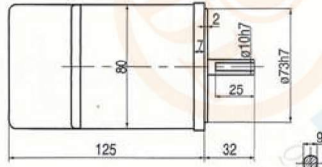

40W

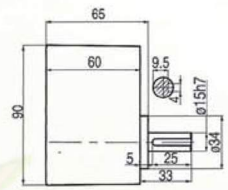
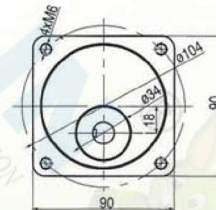
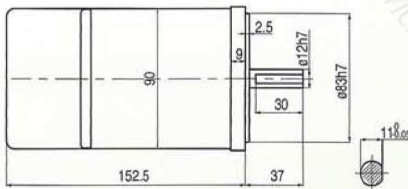

60W

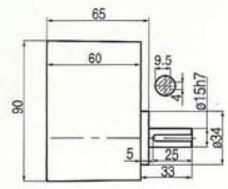
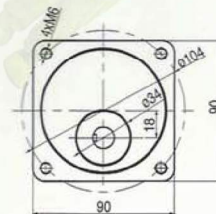
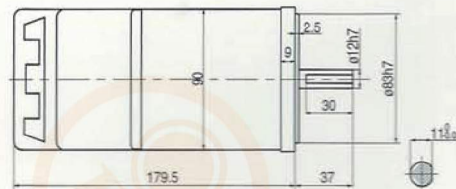

90W-120W

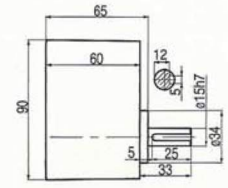
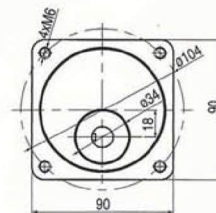
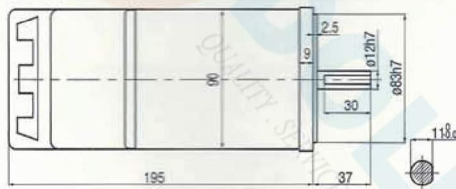

120W-200W

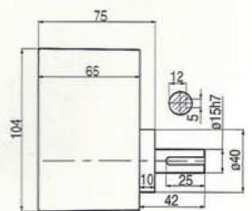
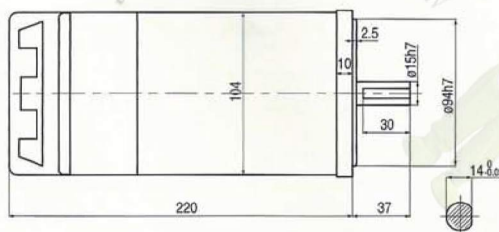

剎車電機
Brake Motor

电机特性表 List of Motor Characteristics

型号/类型 Model / Type		额定功率 Rated Power	电压 Voltage	频率 Frequency	极数 Poles	额定转速 Rated Speed	启动转矩 Rated Torque	额定转矩 Rated Current	额定电流 Starting Torque	电容 Capacitor
光轴 Round shaft	齿轴 Pinion shaft	W	V	Hz	P	RPM	MN·M	MN·M	A	μf/450V
3RK15A-AM	3RK15GN-AM	15	1ph110	50/60	4	1300	0.12	0.11	0.32	6.0
3RK15A-CM	3RK15GN-CM	15	1ph220	50/60	4	1300	0.12	0.11	0.17	1.5
3RK15A-SM	3RK15GN-SM	15	3ph220	50/60	4	1300	0.14	0.19	0.13	/
3RK15A-S ₃ M	3RK15GN-S ₃ M	15	3ph380	50/60	4	1300	0.14	0.18	0.11	/
4RK25A-AM	4RK25GN-AM	25	1ph110	50/60	4	1350	0.17	0.18	0.43	6.0
4RK25A-CM	4RK25GN-CM	25	1ph220	50/60	4	1350	0.14	0.18	0.24	2.0
4RK25A-SM	4RK25GN-SM	25	3ph220	50/60	4	1300	0.52	0.19	0.25	/
4RK25A-S ₃ M	4RK25GN-S ₃ M	25	3ph380	50/60	4	1300	0.52	0.19	0.14	/
5RK40A1-AM	5RK40GN-AM	40	1ph110	50/60	4	1350	0.30	0.29	0.68	12.0
5RK40A1-CM	5RK40GN-CM	40	1ph220	50/60	4	1350	0.30	0.29	0.35	2.5
5RK40A1-SM	5RK40GN-SM	40	3ph220	50/60	4	1300	1.15	0.29	0.38	/
5RK40A1-S ₃ M	5RK40GN-S ₃ M	40	3ph380	50/60	4	1300	1.15	0.29	0.22	/
5RK60A1-AFM	5RK60GN-AFM	60	1ph110	50/60	4	1350	0.45	0.44	1.10	12.0
5RK60A1-CFM	5RK60GN-CFM	60	1ph220	50/60	4	1350	0.45	0.44	0.45	3.5
5RK60A1-SFM	5RK60GN-SFM	60	3ph220	50/60	4	1350	1.70	0.46	0.49	/
5RK60A1-S ₃ FM	5RK60GN-S ₃ FM	60	3ph380	50/60	4	1350	1.70	0.46	0.28	/
5RK90A1-AFM	5RK90GU-AFM	90	1ph110	50/60	4	1350	0.48	0.64	1.55	18.0
5RK90A1-CFM	5RK90GU-CFM	90	1ph220	50/60	4	1350	0.48	0.64	0.59	5.0
5RK90A1-SFM	5RK90GU-SFM	90	3ph220	50/60	4	1350	2.30	0.66	0.66	/
5RK90A1-S ₃ FM	5RK90GU-S ₃ FM	90	3ph380	50/60	4	1350	2.30	0.66	0.28	/
5RK120A1-AFM	5RK120GU-AFM	120	1ph110	50/60	4	1300	0.78	0.90	2.10	18.0
5RK120A1-CFM	5RK120GU-CFM	120	1ph220	50/60	4	1300	0.75	0.87	0.92	6.5
5RK120A1-SFM	5RK120GU-SFM	120	3ph220	50/60	4	1300	3.00	0.87	0.86	/
5RK120A1-S ₃ FM	5RK120GU-S ₃ FM	120	3ph380	50/60	4	1300	3.00	0.87	0.51	/
5RK180A1-AFM	5RK180GU-AFM	180	1ph110	50/60	4	1350	0.97	1.27	2.40	30.0
5RK180A1-CFM	5RK180GU-CFM	180	1ph220	50/60	4	1350	1.12	1.23	1.21	12.0
5RK180A1-SFM	5RK180GU-SFM	180	3ph220	50/60	4	1350	4.50	1.23	0.83	/
5RK180A1-S ₃ FM	5RK180GU-S ₃ FM	180	3ph380	50/60	4	1350	4.50	1.23	0.59	/
6RK120A1-AFM	6RK120GU-AFM	120	1ph110	50/60	4	1350	0.59	0.85	1.90	30.0
6RK120A1-CFM	6RK120GU-CFM	120	1ph220	50/60	4	1350	0.75	0.85	0.88	8.0
6RK120A1-SFM	6RK120GU-SFM	120	3ph220	50/60	4	1350	3.50	0.85	0.89	/
6RK120A1-S ₃ FM	6RK120GU-S ₃ FM	120	3ph380	50/60	4	1350	3.50	0.85	0.51	/
6RK140A1-AFM	6RK140GU-AFM	140	1ph110	50/60	4	1350	0.90	0.99	2.00	30.0
6RK140A1-CFM	6RK140GU-CFM	140	1ph220	50/60	4	1350	0.90	0.99	1.13	8.0
6RK140A1-SFM	6RK140GU-SFM	140	3ph220	50/60	4	1350	3.50	0.99	0.95	/
6RK140A1-S ₃ FM	6RK140GU-S ₃ FM	140	3ph380	50/60	4	1350	3.50	0.99	0.55	/
6RK180A1-AFM	6RK180GU-AFM	180	1ph110	50/60	4	1350	0.63	1.25	1.90	30.0
6RK180A1-CFM	6RK180GU-CFM	180	1ph220	50/60	4	1350	0.81	1.25	1.17	10.0
6RK180A1-SFM	6RK180GU-SFM	180	3ph220	50/60	4	1350	4.60	1.25	0.89	/
6RK180A1-S ₃ FM	6RK180GU-S ₃ FM	180	3ph380	50/60	4	1350	4.60	1.25	0.51	/
6RK200A1-AFM	6RK200GU-AFM	200	1ph110	50/60	4	1350	1.32	1.32	2.80	30.0
6RK200A1-CFM	6RK200GU-CFM	200	1ph220	50/60	4	1350	1.32	1.32	1.25	10.0
6RK200A1-SFM	6RK200GU-SFM	200	3ph220	50/60	4	1350	4.70	1.32	0.95	/
6RK200A1-S ₃ FM	6RK200GU-S ₃ FM	200	3ph380	50/60	4	1350	4.70	1.32	0.55	/

●使用电压不同, 电容容量也不相同。故应和使用电压相对应, 正确使用。●不能正确使用是造成故障的主要原因。订货时, 在确认使用电压后, 选择正确的型号进行订货。
 ●The capacitor capacitance will be different under different voltage. A correct capacitor capacitance is required to match the applied voltage. ●Wrong capacitor capacitance is the cause of trouble.
 You must confirm a correct voltage and select a correct model when your purchase order is placed.

装有减速机时的容许转矩 allowable torque with gearbox

50Hz电机 单位: kgf.cm/N.m

转速Output Shaft Speed	500	417	300	250	200	166	150	120	100	83	75	60	50	41	37	30	25	20	16	15	12	10	8	7.5
减速比Reduction Ratio	3	3.6	5	6	7.5	9	10	12.5	15	18	20	25	30	36	40	50	60	75	90	100	120	150	180	200
3RK15GN-□ 3GN□K	3.4	4.1	5.7	6.8	8.5	10.2	11.3	14.2	17	20.4	20.4	25.6	30.7	36.8	40.9	46.2	55.4	69.2	80	80	80	80	80	80
	0.333	0.402	0.559	0.666	0.833	1	1.107	1.392	1.666	1.999	1.999	2.509	3.009	3.606	4.008	4.53	5.423	6.786	7.84	7.84	7.84	7.84	7.84	7.84
4RK25GN-□ 4GN□K	5.3	6.4	8.9	10.7	13.4	16.0	17.8	22.3	26.7	32.1	32.1	40.2	48.2	57.8	64.2	72.6	80.0	80.0	80.0	80.0	80.0	80.0	80.0	80.0
	0.519	0.627	0.872	1.049	1.313	1.568	1.744	2.185	2.617	3.146	3.146	3.940	4.724	5.664	6.292	7.115	7.84	7.84	7.84	7.84	7.84	7.84	7.84	7.84
5RK40GN-□ 5GN□K	8.3	9.9	13.8	16.5	20.7	24.8	27.5	34.4	41.3	49.6	62.1	74.5	89.4	99.3	100.0	100.0	100.0	100.0	100.0	100.0	100.0	100.0	100.0	100.0
	0.813	0.970	1.352	1.617	2.029	2.430	2.695	3.371	4.047	4.861	4.861	6.086	7.301	8.761	9.731	9.80	9.80	9.80	9.80	9.80	9.80	9.80	9.80	9.80
5RK60GN-□ 5GN□K	12.2	14.6	20.3	24.3	30.4	36.5	40.5	45.6	54.8	65.7	73.0	82.5	99.0	119.0	132.0	165.0	198.0	200.0	200.0	200.0	200.0	200.0	200.0	200.0
	1.196	1.431	1.989	2.381	2.989	3.577	3.969	4.469	5.370	6.439	7.154	8.085	9.702	11.66	12.94	16.17	19.40	19.60	19.60	19.60	19.60	19.60	19.60	19.60
5RK90GU-□ 5GU□K	18.2	21.9	30.4	36.5	45.6	54.7	60.8	68.4	82.1	98.6	110.0	124.0	149.0	178.0	198.0	200.0	200.0	200.0	200.0	200.0	200.0	200.0	200.0	200.0
	1.784	2.145	2.979	3.577	4.469	5.361	5.958	6.703	8.046	9.663	10.78	12.15	14.60	17.44	19.40	19.60	19.60	19.60	19.60	19.60	19.60	19.60	19.60	19.60
5RK120GU-□ 5GU□K	23.2	27.8	38.7	46.4	58.0	69.6	77.4	87.0	104.0	125.0	139.0	156.0	188.0	200.0	200.0	200.0	200.0	200.0	200.0	200.0	200.0	200.0	200.0	200.0
	2.276	2.731	3.793	4.552	5.689	6.827	7.586	8.534	10.24	12.29	13.65	15.36	18.43	19.61	19.61	19.61	19.61	19.61	19.61	19.61	19.61	19.61	19.61	19.61
5RK180GU-□ 5GU□K	34.0	41.0	57.0	68.0	85.1	102.0	113.0	128.0	153.0	184.0	204.0	230.0	278.0	300.0	300.0	300.0	300.0	300.0	300.0	300.0	300.0	300.0	300.0	300.0
	3.336	4.021	5.590	6.672	8.341	10.01	11.12	12.55	15.01	18.04	20.02	22.56	27.26	29.42	29.42	29.42	29.42	29.42	29.42	29.42	29.42	29.42	29.42	29.42
6RK120GU-□ 6GU□K	21.0	25.3	35.1	42.1	52.6	63.2	63.2	79.1	94.9	114.0	114.0	143.0	171.0	206.0	228.0	286.0	343.0	400.0	400.0	400.0	400.0	400.0	400.0	400.0
	2.06	2.48	3.44	4.13	5.16	6.19	6.19	7.75	9.30	11.20	11.20	14.00	16.80	20.00	22.40	28.00	33.60	39.20	39.20	39.20	39.20	39.20	39.20	39.20
6RK140GU-□ 6GU□K	24.1	28.8	40.1	48.1	60.1	72.1	72.1	90.3	108.0	130.0	130.0	163.0	196.0	235.0	261.0	327.0	392.0	400.0	400.0	400.0	400.0	400.0	400.0	400.0
	2.36	2.83	3.93	4.71	5.89	7.07	7.07	8.85	10.60	12.70	12.70	16.00	19.20	23.00	25.60	32.00	38.40	39.20	39.20	39.20	39.20	39.20	39.20	39.20
6RK180GU-□ 6GU□K	24.1	28.8	40.1	48.1	60.1	72.1	72.1	90.3	108.0	130.0	130.0	163.0	196.0	235.0	261.0	327.0	392.0	400.0	400.0	400.0	400.0	400.0	400.0	400.0
	2.36	2.83	3.93	4.71	5.89	7.07	7.07	8.85	10.60	12.70	12.70	16.00	19.20	23.00	25.60	32.00	38.40	39.20	39.20	39.20	39.20	39.20	39.20	39.20
6RK200GU-□ 6GU□K	24.1	28.8	40.1	48.1	60.1	72.1	72.1	90.3	108.0	130.0	130.0	163.0	196.0	235.0	261.0	327.0	392.0	400.0	400.0	400.0	400.0	400.0	400.0	400.0
	2.36	2.83	3.93	4.71	5.89	7.07	7.07	8.85	10.60	12.70	12.70	16.00	19.20	23.00	25.60	32.00	38.40	39.20	39.20	39.20	39.20	39.20	39.20	39.20

60Hz电机 单位: kgf.cm/N.m

转速Output Shaft Speed	600	500	360	300	240	200	180	144	120	100	90	72	60	50	45	36	30	24	20	18	15	12	10	9
减速比Reduction Ratio	3	3.6	5	6	7.5	9	10	12.5	15	18	20	25	30	36	40	50	60	75	90	100	120	150	180	200
3RK15GN-□ 3GN□K	2.9	3.5	4.9	5.8	7.3	8.7	9.7	12.2	14.6	17.5	17.5	21.9	26.3	31.5	35	39.6	47.5	59.4	71.3	79.2	80	80	80	80
	0.284	0.343	0.481	0.568	0.715	0.853	0.951	1.196	1.432	1.715	1.715	2.416	2.577	3.087	3.43	3.883	4.658	5.825	6.992	7.767	7.84	7.84	7.84	7.84
4RK25GN-□ 4GN□K	4.4	5.2	7.3	8.7	10.9	13.1	14.6	18.2	21.9	26.2	26.3	32.9	39.4	47.3	52.6	59.4	71.3	80.0	80.0	80.0	80.0	80.0	80.0	80.0
	0.431	0.510	0.715	0.853	1.068	1.284	1.431	1.784	2.146	2.568	2.577	3.224	3.861	4.635	5.155	5.821	6.987	7.84	7.84	7.84	7.84	7.84	7.84	7.84
5RK40GN-□ 5GN□K	6.8	8.2	11.3	13.6	17.0	20.4	22.7	28.4	34.0	40.8	40.9	51.1	61.3	73.6	81.8	100.0	100.0	100.0	100.0	100.0	100.0	100.0	100.0	100.0
	0.666	0.804	1.107	1.333	1.666	1.999	2.225	2.783	3.332	3.998	4.008	5.008	6.007	7.213	8.016	9.800	9.800	9.800	9.800	9.800	9.800	9.800	9.800	9.800
5RK60GN-□ 5GN□K	9.7	11.7	16.2	19.4	24.3	29.2	32.4	36.5	43.8	52.6	58.4	66.0	79.2	95.0	106.0	132.0	158.0	177.0	200.0	200.0	200.0	200.0	200.0	200.0
	0.953	1.147	1.588	1.901	2.381	2.862	3.175	3.577	4.292	5.155	5.726	6.648	7.762	9.31	10.39	12.94	15.48	17.35	19.60	19.60	19.60	19.60	19.60	19.60
5RK90GU-□ 5GU□K	14.6	17.5	24.3	29.2	36.5	43.7	48.6	54.8	65.7	78.8	87.6	99.0	119.0	143.0	158.0	198.0	200.0	200.0	200.0	200.0	200.0	200.0	200.0	200.0
	1.431	1.715	2.381	2.862	3.577	4.675	4.763	5.370	6.439	7.722	8.585	9.702	11.66	14.01	15.48	19.40	19.60	19.60	19.60	19.60	19.60	19.60	19.60	19.60
5RK120GU-□ 5GU□K	18.7	22.5	31.2	37.4	46.8	56.1	62.4	70.2	84.2	101.0	112.0	126.0	152.0	182.0	200.0	200.0	200.0	200.0	200.0	200.0	200.0	200.0	200.0	200.0
	1.835	2.202	3.058	3.670	4.587	5.505	6.116	6.881	8.257	9.909	11.01	12.39	14.86	17.84	19.61	19.61	19.61	19.61	19.61	19.61	19.61	19.61	19.61	19.61
5RK180GU-□ 5GU□K	28.1	34.0	47.0	57.0	71.0	84.2	94.0	105.0	126.0	152.0	168.0	189.0	227.0	273.0	300.0	300.0	300.0	300.0	300.0	300.0	300.0	300.0	300.0	300.0
	2.756	3.334	4.609	5.590	6.963	8.257	9.218	10.30	12.39	14.91	16.51	18.58	22.29	26.75	29.42	29.42	29.42	29.42	29.42	29.42	29.42	29.42	29.42	29.42
6RK120GU-□ 6GU□K	17.8	21.3	29.6	35.5	44.4	53.3	53.3	69.7	80.0	96.1	96.1	121.0	146.0	174.0	193.0	241.0	289.0	362.0	400.0	400.0	400.0	400.0	400.0	400.0
	1.74	2.09	2.90	3.48	4.35	5.22	5.22	6.54	7.85	9.42	9.42	11.80	14.20	17.00	18.90	23.60	28.40	35.50	39.20	39.20	39.20	39.20	39.20	39.20
6RK140GU-□ 6GU□K	20.7	24.9	34.6	41.2	51.8	62.1	62.1	77.6	93.4	112.0	112.0	141.0	169.0	203.0	226.0	282.0	338.0	400.0	400.0	400.0	400.0	400.0	400.0	400.0
	2.03	2.44	3.39	4.06	5.08	6.09	6.09	7.60	9.15	11.00	11.00	13.80	16.60	19.90	22.10	27.60	33.10	39.20	39.20	39.20	39.20	39.20	39.20	39.20
6RK180GU-□ 6GU□K	20.7	24.9	34.6	41.2	51.8	62.1	62.1	77.6	93.4	112.0	112.0	141.0	169.0	203.0	226.0	282.0	338.0	400.0	400.0	400.0	400.0	400.0	400.0	400.0
	2.03	2.44	3.39	4.06	5.08	6.09	6.09	7.60	9.15	11.00	11.00	13.80	16.60	19.90	22.10	27.60	33.10	39.20	39.20	39.20	39.20	39.20	39.20	39.20
6RK200GU-□ 6GU□K	20.7	24.9	34.6	41.2	51.8	62.1	62.1	77.6	93.4	112.0	112.0	141.0	203.0	226.0	282.0	338.0	400.0	400.0	400.0	400.0	400.0	400.0	400.0	400.0
	2.03	2.44	3.39	4.06	5.08	6.09	6.09	7.60	9.15	11.00	11.00	13.80	16.60	19.90	22.10	27.60	33.10	39.20	39.20	39.20	39.20	39.20	39.20	39.20

刹车电机 Brake Motor

电机特性表 List of Motor Characteristics

型号/类型 Model / Type		额定功率 Rated Power	电压 Voltage	频率 Frequency	极数 Poles	额定转速 Rated Speed	启动转矩 Rated Torque	额定转矩 Rated Current	额定电流 Starting Torque	电容 Capacitor
光轴 Round shaft	齿轴 Pinion shaft	W	V	Hz	P	RPM	MN-M	MN-M	A	μf/450V
3IK15RA-A	3IK15RGN-A	15	1ph110	50/60	4	90-1350	0.06	0.04	0.12	6.0
3IK15RA-C	3IK15RGN-C	15	1ph220	50/60	4	90-1350	0.06	0.04	0.12	1.5
4IK25RA-A	4IK25RGN-C	25	1ph110	50/60	4	90-1350	0.13	0.05	0.19	6.0
4IK25RA-C	4IK25RGN-C	25	1ph220	50/60	4	90-1350	0.13	0.05	0.19	2.0
5IK40RA1-A	5IK40RGN-A	40	1ph110	50/60	4	90-1350	0.19	0.06	0.30	10.0
5IK40RA1-C	5IK40RGN-C	40	1ph220	50/60	4	90-1350	0.19	0.06	0.30	2.5
5IK60RA1-AF	5IK60RGN-AF	60	1ph110	50/60	4	90-1350	0.31	0.14	0.50	12.0
5IK60RA1-CF	5IK60RGN-CF	60	1ph220	50/60	4	90-1350	0.33	0.14	0.50	3.5
5IK90RA1-AF	5IK90RGU-AF	90	1ph110	50/60	4	90-1350	0.48	0.23	0.71	18.0
5IK90RA1-CF	5IK90RGU-CF	90	1ph220	50/60	4	90-1350	0.45	0.23	0.71	5.0
5IK120RA1-AF	5IK120RGU-AF	120	1ph110	50/60	4	90-1350	0.55	0.40	0.75	18.0
5IK120RA1-CF	5IK120RGU-CF	120	1ph220	50/60	4	90-1350	0.55	0.40	0.75	6.5
5IK180RA1-AF	5IK180RGU-AF	180	1ph110	50/60	4	90-1350	0.97	1.27	2.40	30.0
5IK180RA1-CF	5IK180RGU-CF	180	1ph220	50/60	4	90-1350	1.12	1.23	1.21	12.0
6IK120RA1-AF	6IK120RGU-AF	120	1ph110	50/60	4	90-1350	0.51	0.40	0.75	30.0
6IK120RA1-CF	6IK120RGU-CF	120	1ph220	50/60	4	90-1350	0.65	0.40	0.75	8.0
6IK140RA1-AF	6IK140RGU-AF	140	1ph110	50/60	4	90-1350	0.62	0.45	0.85	30.0
6IK140RA1-CF	6IK140RGU-CF	140	1ph220	50/60	4	90-1350	0.68	0.45	0.85	8.0
6IK180RA1-AF	6IK180RGU-AF	180	1ph110	50/60	4	90-1350	0.80	0.63	1.20	30.0
6IK180RA1-CF	6IK180RGU-CF	180	1ph220	50/60	4	90-1350	0.92	0.63	1.20	10.0
6IK200RA1-AF	6IK200RGU-AF	200	1ph110	50/60	4	90-1350	0.84	0.67	1.32	30.0
6IK200RA1-CF	6IK200RGU-CF	200	1ph220	50/60	4	90-1350	0.84	0.67	1.32	8.0

●使用电压不同，电容容量也不相同。故应与使用电压相对应，正确使用。●不能正确使用是造成故障的主要原因。订货时，在确认使用电压后，选择正确的型号进行订货。
 ●The capacitor capacitance will be different under different voltage. A correct capacitor capacitance is required to match the applied voltage. ●Wrong capacitor capacitance is the cause of trouble. You must confirm a correct voltage and select a correct model when your purchase order is placed.

 调速电机
 Speed Adjustable Motor

装有减速机时的容许转矩 allowable torque with gearbox

50Hz电机 单位: kgf.cm/N.m

转速Output Shaft Speed	500	417	300	250	200	166	150	120	100	83	75	60	50	41	37	30	25	20	16	15	12	10	8	7.5
减速比Reduction Ratio	3	3.6	5	6	7.5	9	10	12.5	15	18	20	25	30	36	40	50	60	75	90	100	120	150	180	200
3IK15RGN-□ 3GN□K	3.2	3.9	5.4	6.5	8.1	9.7	10.8	13.5	16.2	19.4	19.4	24.2	29.1	34.9	38.8	43.6	50.0	50.0	50.0	50.0	50.0	50.0	50.0	50.0
	0.314	0.382	0.530	0.637	0.794	0.951	1.059	1.324	1.587	1.902	1.902	2.373	2.854	3.423	3.805	4.276	4.90	4.90	4.90	4.90	4.90	4.90	4.90	4.90
4IK25RGN-□ 4GN□K	5.3	6.4	8.9	10.7	13.4	16.0	17.8	22.3	26.7	32.1	32.1	40.2	48.2	57.8	64.2	72.6	80.0	80.0	80.0	80.0	80.0	80.0	80.0	80.0
	0.519	0.627	0.872	1.049	1.313	1.568	1.744	2.185	2.617	3.146	3.146	3.940	4.724	5.664	6.292	7.115	7.84	7.84	7.84	7.84	7.84	7.84	7.84	7.84
5IK40RGN-□ 5GN□K	8.3	9.9	13.8	16.5	20.7	24.8	27.5	34.4	41.3	49.6	62.1	74.5	89.4	99.3	100.0	100.0	100.0	100.0	100.0	100.0	100.0	100.0	100.0	100.0
	0.813	0.970	1.352	1.617	2.029	2.430	2.695	3.371	4.047	4.861	4.861	6.086	7.301	8.761	9.731	9.80	9.80	9.80	9.80	9.80	9.80	9.80	9.80	9.80
5IK60RGN-□ 5GN□K	12.2	14.6	20.3	24.3	30.4	36.5	40.5	45.6	54.8	65.7	73.0	82.5	99.0	119.0	132.0	165.0	198.0	200.0	200.0	200.0	200.0	200.0	200.0	200.0
	1.196	1.431	1.989	2.381	2.989	3.577	3.969	4.469	5.370	6.439	7.154	8.085	9.702	11.66	12.94	16.17	19.40	19.60	19.60	19.60	19.60	19.60	19.60	19.60
5IK90RGU-□ 5GU□K	18.2	21.9	30.4	36.5	45.6	54.7	60.8	68.4	82.1	98.6	110.0	124.0	149.0	178.0	198.0	200.0	200.0	200.0	200.0	200.0	200.0	200.0	200.0	200.0
	1.784	2.145	2.979	3.577	4.469	5.361	5.958	6.703	8.046	9.663	10.78	12.15	14.60	17.44	19.40	19.60	19.60	19.60	19.60	19.60	19.60	19.60	19.60	19.60
5IK120RGU-□ 5GU□K	23.2	27.8	38.7	46.4	58.0	69.6	77.4	87.0	104.0	125.0	139.0	156.0	188.0	200.0	200.0	200.0	200.0	200.0	200.0	200.0	200.0	200.0	200.0	200.0
	2.276	2.731	3.793	4.552	5.689	6.827	7.586	8.534	10.24	12.29	13.65	15.36	18.43	19.61	19.61	19.61	19.61	19.61	19.61	19.61	19.61	19.61	19.61	19.61
5IK180RGU-□ 5GU□K	34.0	41.0	57.0	68.0	85.1	102.0	113.0	128.0	153.0	184.0	204.0	230.0	278.0	300.0	300.0	300.0	300.0	300.0	300.0	300.0	300.0	300.0	300.0	300.0
	3.336	4.021	5.590	6.672	8.341	10.01	11.12	12.55	15.01	18.04	20.02	22.56	27.26	29.42	29.42	29.42	29.42	29.42	29.42	29.42	29.42	29.42	29.42	29.42
6IK120RGU-□ 6GU□K	21.0	25.3	35.1	42.1	52.6	63.2	63.2	79.1	94.9	114.0	114.0	143.0	171.0	206.0	228.0	286.0	343.0	400.0	400.0	400.0	400.0	400.0	400.0	400.0
	2.06	2.48	3.44	4.13	5.16	6.19	6.19	7.75	9.30	11.20	11.20	14.00	16.80	20.00	22.40	28.00	33.60	39.20	39.20	39.20	39.20	39.20	39.20	39.20
6IK140RGU-□ 6GU□K	24.1	28.8	40.1	48.1	60.1	72.1	72.1	90.3	108.0	130.0	130.0	163.0	196.0	235.0	261.0	327.0	392.0	400.0	400.0	400.0	400.0	400.0	400.0	400.0
	2.36	2.83	3.93	4.71	5.89	7.07	7.07	8.85	10.60	12.70	12.70	16.00	19.20	23.00	25.60	32.00	38.40	39.20	39.20	39.20	39.20	39.20	39.20	39.20
6IK180RGU-□ 6GU□K	24.1	28.8	40.1	48.1	60.1	72.1	72.1	90.3	108.0	130.0	130.0	163.0	196.0	235.0	261.0	327.0	392.0	400.0	400.0	400.0	400.0	400.0	400.0	400.0
	2.36	2.83	3.93	4.71	5.89	7.07	7.07	8.85	10.60	12.70	12.70	16.00	19.20	23.00	25.60	32.00	38.40	39.20	39.20	39.20	39.20	39.20	39.20	39.20
6IK200RGU-□ 6GU□K	24.1	28.8	40.1	48.1	60.1	72.1	72.1	90.3	108.0	130.0	130.0	163.0	196.0	235.0	261.0	327.0	392.0	400.0	400.0	400.0	400.0	400.0	400.0	400.0
	2.36	2.83	3.93	4.71	5.89	7.07	7.07	8.85	10.60	12.70	12.70	16.00	19.20	23.00	25.60	32.00	38.40	39.20	39.20	39.20	39.20	39.20	39.20	39.20

60Hz电机 单位: kgf.cm/N.m

转速Output Shaft Speed	600	500	360	300	240	200	180	144	120	100	90	72	60	50	45	36	30	24	20	18	15	12	10	9
减速比Reduction Ratio	3	3.6	5	6	7.5	9	10	12.5	15	18	20	25	30	36	40	50	60	75	90	100	120	150	180	200
3IK15RGN-□ 3GN□K	3.0	3.6	5.1	6.1	7.6	9.1	10.1	12.7	15.2	18.2	18.2	22.8	27.3	32.8	36.5	41.0	49.2	50.0	50.0	50.0	50.0	50.0	50.0	50.0
	0.294	0.353	0.500	0.598	0.745	0.892	0.990	1.245	1.491	1.785	1.785	2.236	2.677	3.217	3.579	4.021	4.825	4.90	4.90	4.90	4.90	4.90	4.90	4.90
4IK25RGN-□ 4GN□K	4.4	5.2	7.3	8.7	10.9	13.1	14.6	18.2	21.9	26.2	26.2	32.9	39.4	47.3	52.6	59.4	71.3	80.0	80.0	80.0	80.0	80.0	80.0	80.0
	0.431	0.510	0.715	0.853	1.068	1.284	1.431	1.784	2.146	2.568	2.577	3.224	3.861	4.635	5.155	5.821	6.987	7.84	7.84	7.84	7.84	7.84	7.84	7.84
5IK40RGN-□ 5GN□K	6.8	8.2	11.3	13.6	17.0	20.4	22.7	28.4	34.0	40.8	40.9	51.1	61.3	73.6	81.8	100.0	100.0	100.0	100.0	100.0	100.0	100.0	100.0	100.0
	0.666	0.804	1.107	1.333	1.666	1.999	2.225	2.783	3.332	3.998	4.008	5.008	6.007	7.213	8.016	9.800	9.800	9.800	9.800	9.800	9.800	9.800	9.800	9.800
5IK60RGN-□ 5GN□K	9.7	11.7	16.2	19.4	24.3	29.2	32.4	36.5	43.8	52.6	58.4	66.0	79.2	95.0	106.0	132.0	158.0	177.0	200.0	200.0	200.0	200.0	200.0	200.0
	0.953	1.147	1.588	1.901	2.381	2.862	3.175	3.577	4.292	5.155	5.726	6.648	7.762	9.31	10.39	12.94	15.48	17.35	19.60	19.60	19.60	19.60	19.60	19.60
5IK90RGU-□ 5GU□K	14.6	17.5	24.3	29.2	36.5	43.7	48.6	54.8	65.7	78.8	87.6	99.0	119.0	143.0	158.0	198.0	200.0	200.0	200.0	200.0	200.0	200.0	200.0	200.0
	1.431	1.715	2.381	2.862	3.577	4.675	4.763	5.370	6.439	7.722	8.585	9.702	11.66	14.01	15.48	19.40	19.60	19.60	19.60	19.60	19.60	19.60	19.60	19.60
5IK120RGU-□ 5GU□K	18.7	22.5	31.2	37.4	46.8	56.1	62.4	70.2	84.2	101.0	112.0	126.0	152.0	182.0	200.0	200.0	200.0	200.0	200.0	200.0	200.0	200.0	200.0	200.0
	1.835	2.202	3.058	3.670	4.587	5.505	6.116	6.881	8.257	9.909	11.01	12.39	14.86	17.84	19.61	19.61	19.61	19.61	19.61	19.61	19.61	19.61	19.61	19.61
5IK180RGU-□ 5GU□K	28.1	34.0	47.0	57.0	71.0	84.2	94.0	105.0	126.0	152.0	168.0	189.0	227.0	273.0	300.0	300.0	300.0	300.0	300.0	300.0	300.0	300.0	300.0	300.0
	2.756	3.334	4.609	5.590	6.963	8.257	9.218	10.30	12.39	14.91	16.51	18.58	22.29	26.75	29.42	29.42	29.42	29.42	29.42	29.42	29.42	29.42	29.42	29.42
6IK120RGU-□ 6GU□K	17.8	21.3	29.6	35.5	44.4	53.3	53.3	69.7	80.0	96.1	96.1	121.0	146.0	174.0	193.0	241.0	289.0	362.0	400.0	400.0	400.0	400.0	400.0	400.0
	1.74	2.09	2.90	3.48	4.35	5.22	5.22	6.54	7.85	9.42	9.42	11.80	14.20	17.00	18.90	23.60	28.40	35.50	39.20	39.20	39.20	39.20	39.20	39.20
6IK140RGU-□ 6GU□K	20.7	24.9	34.6	41.2	51.8	62.1	62.1	77.6	93.4	112.0	112.0	141.0	169.0	203.0	226.0	282.0	338.0	400.0	400.0	400.0	400.0	400.0	400.0	400.0
	2.03	2.44	3.39	4.06	5.08	6.09	6.09	7.60	9.15	11.00	11.00	13.80	16.60	19.90	22.10	27.60	33.10	39.20	39.20	39.20	39.20	39.20	39.20	39.20
6IK180RGU-□ 6GU□K	20.7	24.9	34.6	41.2	51.8	62.1	62.1	77.6	93.4	112.0	112.0	141.0	169.0	203.0	226.0	282.0	338.0	400.0	400.0	400.0	400.0	400.0	400.0	400.0
	2.03	2.44	3.39	4.06	5.08	6.09	6.09	7.60	9.15	11.00	11.00	13.80	16.60	19.90	22.10	27.60	33.10	39.20	39.20	39.20	39.20	39.20	39.20	39.20
6IK200RGU-□ 6GU□K	20.7	24.9	34.6	41.2	51.8	62.1	62.1	77.6	93.4	112.0	112.0	141.0	169.0	203.0	226.0	282.0	338.0	400.0	400.0	400.0	400.0	400.0	400.0	400.0
	2.03	2.44	3.39	4.06	5.08	6.09	6.09	7.60	9.15	11.00	11.00	13.80	16.60	19.90	22.10	27.60	33.10	39.20	39.20	39.20	39.20	39.20	39.20	39.20



外形尺寸 Overall Dimension

15W

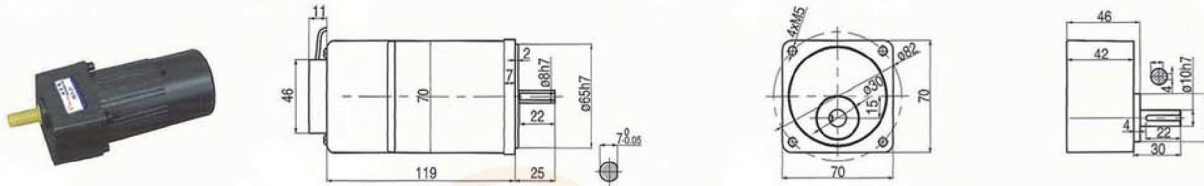

25W

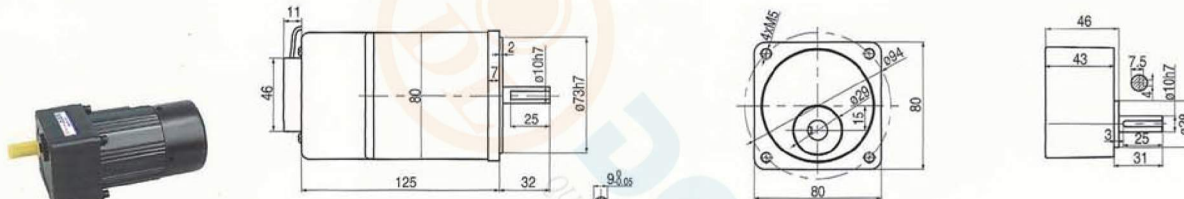

40W

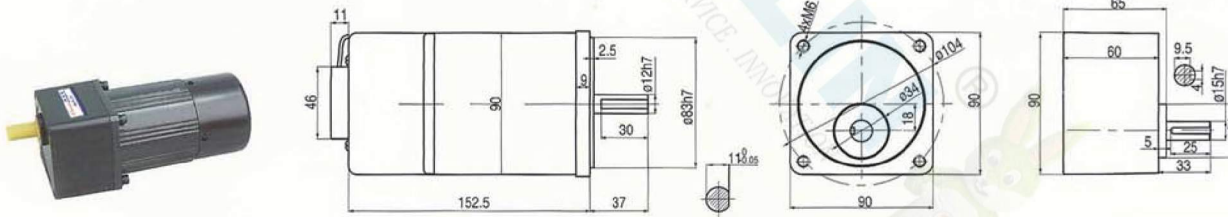

60W

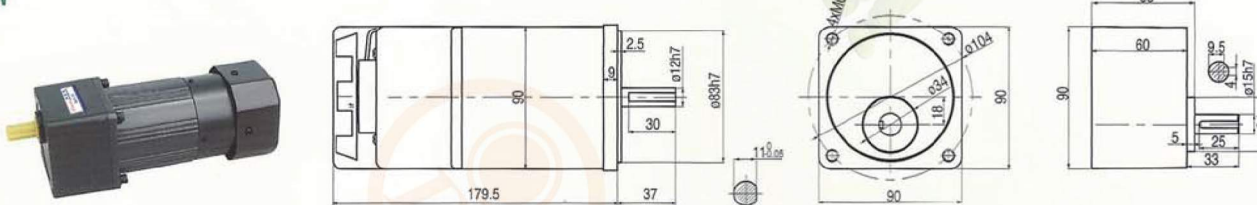

90W-120W

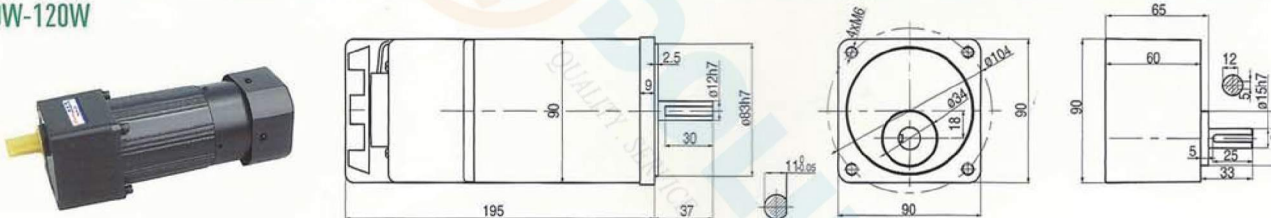

120W-200W

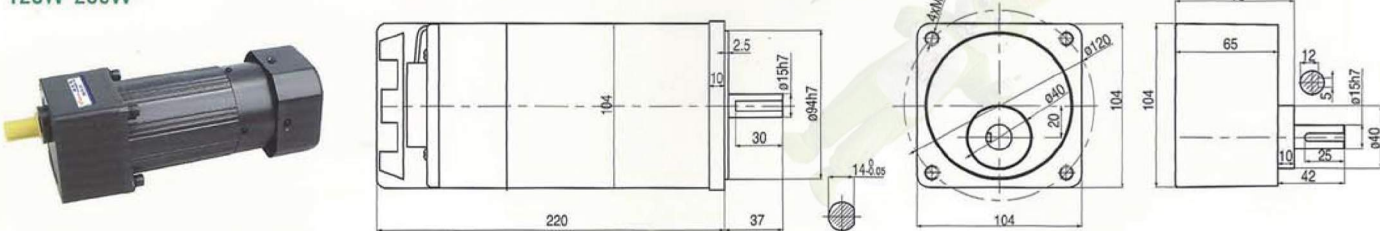

刹车调速电机 Brake Speed Adjustable Motor

电机特性表 List of Motor Characteristics

型号/类型 Model / Type		额定功率 Rated Power	电压 Voltage	频率 Frequency	极数 Poles	额定转速 Rated Speed	启动转矩 Rated Torque	额定转矩 Rated Current	额定电流 Starting Torque	电容 Capacitor
光轴 Round shaft	齿轴 Pinion shaft	W	V	Hz	P	RPM	MN·M	MN·M	A	μf/450V
3RK15RA-AM	3RK15RGN-AM	15	1ph110	50/60	4	1300	0.12	0.11	0.32	6.0
3RK15RA-CM	3RK15RGN-CM	15	1ph220	50/60	4	1300	0.12	0.11	0.17	1.5
3RK15RA-SM	3RK15RGN-SM	15	3ph220	50/60	4	1300	0.14	0.19	0.13	/
3RK15RA-S ₃	3RK15RGN-S ₃	15	3ph380	50/60	4	1300	0.14	0.18	0.11	/
4RK25RA-AM	4RK25RGN-AM	25	1ph110	50/60	4	1350	0.17	0.18	0.43	6.0
4RK25RA-CM	4RK25RGN-CM	25	1ph220	50/60	4	1350	0.14	0.18	0.24	2.0
4RK25RA-SM	4RK25RGN-SM	25	3ph220	50/60	4	1300	0.52	0.19	0.25	/
4RK25RA-S ₃ M	4RK25RGN-S ₃ M	25	3ph380	50/60	4	1300	0.52	0.19	0.14	/
5RK40RA1-AM	5RK40RGN-AM	40	1ph110	50/60	4	1350	0.30	0.29	0.68	12.0
5RK40RA1-CM	5RK40RGN-CM	40	1ph220	50/60	4	1350	0.30	0.29	0.35	2.5
5RK40RA1-SM	5RK40RGN-SM	40	3ph220	50/60	4	1300	1.15	0.29	0.38	/
5RK40RA1-S ₃ M	5RK40RGN-S ₃ M	40	3ph380	50/60	4	1300	1.15	0.29	0.22	/
5RK60RA1-AFM	5RK60RGN-AFM	60	1ph110	50/60	4	1350	0.45	0.44	1.10	12.0
5RK60RA1-CFM	5RK60RGN-CFM	60	1ph220	50/60	4	1350	0.45	0.44	0.45	3.5
5RK60RA1-SFM	5RK60RGN-SFM	60	3ph220	50/60	4	1350	1.70	0.46	0.49	/
5RK60RA1-S ₃ FM	5RK60RGN-S ₃ FM	60	3ph380	50/60	4	1350	1.70	0.46	0.28	/
5RK90RA1-AFM	5RK90RGU-AFM	90	1ph110	50/60	4	1350	0.48	0.64	1.55	18.0
5RK90RA1-CFM	5RK90RGU-CFM	90	1ph220	50/60	4	1350	0.48	0.64	0.59	5.0
5RK90RA1-SFM	5RK90RGU-SFM	90	3ph220	50/60	4	1350	2.30	0.66	0.66	/
5RK90RA1-S ₃ FM	5RK90RGU-S ₃ FM	90	3ph380	50/60	4	1350	2.30	0.66	0.28	/
5RK120RA1-AFM	5RK120RGU-AFM	120	1ph110	50/60	4	1300	0.78	0.90	2.10	18.0
5RK120RA1-CFM	5RK120RGU-CFM	120	1ph220	50/60	4	1300	0.75	0.87	0.92	6.5
5RK120RA1-SFM	5RK120RGU-SFM	120	3ph220	50/60	4	1300	3.00	0.87	0.86	/
5RK120RA1-S ₃ FM	5RK120RGU-S ₃ FM	120	3ph380	50/60	4	1300	3.00	0.87	0.51	/
5RK180RA1-AFM	5RK180RGU-AFM	180	1ph110	50/60	4	1350	0.97	1.27	2.40	30.0
5RK180RA1-CFM	5RK180RGU-CFM	180	1ph220	50/60	4	1350	1.12	1.23	1.21	12.0
5RK180RA1-SFM	5RK180RGU-SFM	180	3ph220	50/60	4	1350	4.50	1.23	0.83	/
5RK180RA1-S ₃ FM	5RK180RGU-S ₃ FM	180	3ph380	50/60	4	1350	4.50	1.23	0.59	/
6RK120RA1-AFM	6RK120RGU-AFM	120	1ph110	50/60	4	1350	0.59	0.85	1.90	30.0
6RK120RA1-CFM	6RK120RGU-CFM	120	1ph220	50/60	4	1350	0.75	0.85	0.88	8.0
6RK120RA1-SFM	6RK120RGU-SFM	120	3ph220	50/60	4	1350	3.50	0.85	0.89	/
6RK120RA1-S ₃ FM	6RK120RGU-S ₃ FM	120	3ph380	50/60	4	1350	3.50	0.85	0.51	/
6RK140RA1-AFM	6RK140RGU-AFM	140	1ph110	50/60	4	1350	0.90	0.99	2.00	30.0
6RK140RA1-CFM	6RK140RGU-CFM	140	1ph220	50/60	4	1350	0.90	0.99	1.13	8.0
6RK140RA1-SFM	6RK140RGU-SFM	140	3ph220	50/60	4	1350	3.50	0.99	0.95	/
6RK140RA1-S ₃ FM	6RK140RGU-S ₃ FM	140	3ph380	50/60	4	1350	3.50	0.99	0.55	/
6RK180RA1-AFM	6RK180RGU-AFM	180	1ph110	50/60	4	1350	0.63	1.25	1.90	30.0
6RK180RA1-CFM	6RK180RGU-CFM	180	1ph220	50/60	4	1350	0.81	1.25	1.17	10.0
6RK180RA1-SFM	6RK180RGU-SFM	180	3ph220	50/60	4	1350	4.60	1.25	0.89	/
6RK180RA1-S ₃ FM	6RK180RGU-S ₃ FM	180	3ph380	50/60	4	1350	4.60	1.25	0.51	/
6RK200RA1-AFM	6RK200RGU-AFM	200	1ph110	50/60	4	1350	1.32	1.32	2.80	30.0
6RK200RA1-CFM	6RK200RGU-CFM	200	1ph220	50/60	4	1350	1.32	1.32	1.25	10.0
6RK200RA1-SFM	6RK200RGU-SFM	200	3ph220	50/60	4	1350	4.70	1.32	0.95	/
6RK200RA1-S ₃ FM	6RK200RGU-S ₃ FM	200	3ph380	50/60	4	1350	4.70	1.32	0.55	/

●使用电压不同，电容容量也不相同。故应与使用电压相对应，正确使用。●不能正确使用是造成故障的主要原因。订货时，在确认使用电压后，选择正确的型号进行订货。
 ●The capacitor capacitance will be different under different voltage. A correct capacitor capacitance is required to match the applied voltage. ●Wrong capacitor capacitance is the cause of trouble. You must confirm a correct voltage and select a correct model when your purchase order is placed.

刹车调速电机 Brake Speed Adjustable Motor

装有减速机时的容许转矩 allowable torque with gearbox

50Hz电机 单位: kgf.cm/N.m

转速Output Shaft Speed	500	417	300	250	200	166	150	120	100	83	75	60	50	41	37	30	25	20	16	15	12	10	8	7.5
减速比Reduction Ratio	3	3.6	5	6	7.5	9	10	12.5	15	18	20	25	30	36	40	50	60	75	90	100	120	150	180	200
3RK15RG-N □ 3GN □ K	3.4	4.1	5.7	6.8	8.5	10.2	11.3	14.2	17	20.4	20.4	25.6	30.7	36.8	40.9	46.2	55.4	69.2	80	80	80	80	80	80
	0.333	0.402	0.559	0.666	0.833	1	1.107	1.392	1.666	1.999	1.999	2.509	3.009	3.606	4.008	4.53	5.423	6.786	7.84	7.84	7.84	7.84	7.84	7.84
4RK25RG-N □ 4GN □ K	5.3	6.4	8.9	10.7	13.4	16.0	17.8	22.3	26.7	32.1	32.1	40.2	48.2	57.8	64.2	72.6	80.0	80.0	80.0	80.0	80.0	80.0	80.0	80.0
	0.519	0.627	0.872	1.049	1.313	1.568	1.744	2.185	2.617	3.146	3.146	3.940	4.724	5.664	6.292	7.115	7.84	7.84	7.84	7.84	7.84	7.84	7.84	7.84
5RK40RG-N □ 5GN □ K	8.3	9.9	13.8	16.5	20.7	24.8	27.5	34.4	41.3	49.6	62.1	74.5	89.4	99.3	100.0	100.0	100.0	100.0	100.0	100.0	100.0	100.0	100.0	
	0.813	0.970	1.352	1.617	2.029	2.430	2.695	3.371	4.047	4.861	4.861	6.086	7.301	8.761	9.731	9.80	9.80	9.80	9.80	9.80	9.80	9.80	9.80	9.80
5RK60RG-N □ 5GN □ K	12.2	14.6	20.3	24.3	30.4	36.5	40.5	45.6	54.8	65.7	73.0	82.5	99.0	119.0	132.0	165.0	198.0	200.0	200.0	200.0	200.0	200.0	200.0	200.0
	1.196	1.431	1.989	2.381	2.989	3.577	3.969	4.469	5.370	6.439	7.154	8.085	9.702	11.66	12.94	16.17	19.40	19.60	19.60	19.60	19.60	19.60	19.60	19.60
5RK90RG-U □ 5GU □ K	18.2	21.9	30.4	36.5	45.6	54.7	60.8	68.4	82.1	98.6	110.0	124.0	149.0	178.0	198.0	200.0	200.0	200.0	200.0	200.0	200.0	200.0	200.0	200.0
	1.784	2.145	2.979	3.577	4.469	5.361	5.958	6.703	8.046	9.663	10.78	12.15	14.60	17.44	19.40	19.60	19.60	19.60	19.60	19.60	19.60	19.60	19.60	19.60
5RK120RG-U □ 5GU □ K	23.2	27.8	38.7	46.4	58.0	69.6	77.4	87.0	104.0	125.0	139.0	156.0	188.0	200.0	200.0	200.0	200.0	200.0	200.0	200.0	200.0	200.0	200.0	200.0
	2.276	2.731	3.793	4.552	5.689	6.827	7.586	8.534	10.24	12.29	13.65	15.36	18.43	19.61	19.61	19.61	19.61	19.61	19.61	19.61	19.61	19.61	19.61	19.61
5RK180RG-U □ 5GU □ K	34.0	41.0	57.0	68.0	85.1	102.0	113.0	128.0	153.0	184.0	204.0	230.0	278.0	300.0	300.0	300.0	300.0	300.0	300.0	300.0	300.0	300.0	300.0	300.0
	3.336	4.021	5.590	6.672	8.341	10.01	11.12	12.55	15.01	18.04	20.02	22.56	27.26	29.42	29.42	29.42	29.42	29.42	29.42	29.42	29.42	29.42	29.42	29.42
6RK120RG-U □ 6GU □ K	21.0	25.3	35.1	42.1	52.6	63.2	63.2	79.1	94.9	114.0	114.0	143.0	171.0	206.0	228.0	286.0	343.0	400.0	400.0	400.0	400.0	400.0	400.0	400.0
	2.06	2.48	3.44	4.13	5.16	6.19	6.19	7.75	9.30	11.20	11.20	14.00	16.80	20.00	22.40	28.00	33.60	39.20	39.20	39.20	39.20	39.20	39.20	39.20
6RK140RG-U □ 6GU □ K	24.1	28.8	40.1	48.1	60.1	72.1	72.1	90.3	108.0	130.0	130.0	163.0	196.0	235.0	261.0	327.0	392.0	400.0	400.0	400.0	400.0	400.0	400.0	400.0
	2.36	2.83	3.93	4.71	5.89	7.07	7.07	8.85	10.60	12.70	12.70	16.00	19.20	23.00	25.60	32.00	38.40	39.20	39.20	39.20	39.20	39.20	39.20	39.20
6RK180RG-U □ 6GU □ K	24.1	28.8	40.1	48.1	60.1	72.1	72.1	90.3	108.0	130.0	130.0	163.0	196.0	235.0	261.0	327.0	392.0	400.0	400.0	400.0	400.0	400.0	400.0	400.0
	2.36	2.83	3.93	4.71	5.89	7.07	7.07	8.85	10.60	12.70	12.70	16.00	19.20	23.00	25.60	32.00	38.40	39.20	39.20	39.20	39.20	39.20	39.20	39.20
6RK200RG-U □ 6GU □ K	24.1	28.8	40.1	48.1	60.1	72.1	72.1	90.3	108.0	130.0	130.0	163.0	196.0	235.0	261.0	327.0	392.0	400.0	400.0	400.0	400.0	400.0	400.0	400.0
	2.36	2.83	3.93	4.71	5.89	7.07	7.07	8.85	10.60	12.70	12.70	16.00	19.20	23.00	25.60	32.00	38.40	39.20	39.20	39.20	39.20	39.20	39.20	39.20

60Hz电机 单位: kgf.cm/N.m

转速Output Shaft Speed	600	500	360	300	240	200	180	144	120	100	90	72	60	50	45	36	30	24	20	18	15	12	10	9
减速比Reduction Ratio	3	3.6	5	6	7.5	9	10	12.5	15	18	20	25	30	36	40	50	60	75	90	100	120	150	180	200
3RK15RG-N □ 3GN □ K	2.9	3.5	4.9	5.8	7.3	8.7	9.7	12.2	14.6	17.5	17.5	21.9	26.3	31.5	35	39.6	47.5	59.4	71.3	79.2	80	80	80	80
	0.284	0.343	0.481	0.568	0.715	0.853	0.951	1.196	1.432	1.715	1.715	2.416	2.577	3.087	3.43	3.883	4.658	5.825	6.992	7.767	7.84	7.84	7.84	7.84
4RK25RG-N □ 4GN □ K	4.4	5.2	7.3	8.7	10.9	13.1	14.6	18.2	21.9	26.2	26.3	32.9	39.4	47.3	52.6	59.4	71.3	80.0	80.0	80.0	80.0	80.0	80.0	80.0
	0.431	0.510	0.715	0.853	1.068	1.284	1.431	1.784	2.146	2.568	2.577	3.224	3.861	4.635	5.155	5.821	6.987	7.84	7.84	7.84	7.84	7.84	7.84	7.84
5RK40RG-N □ 5GN □ K	6.8	8.2	11.3	13.6	17.0	20.4	22.7	28.4	34.0	40.8	40.9	51.1	61.3	73.6	81.8	100.0	100.0	100.0	100.0	100.0	100.0	100.0	100.0	100.0
	0.666	0.804	1.107	1.333	1.666	1.999	2.225	2.783	3.332	3.998	4.008	5.008	6.007	7.213	8.016	9.800	9.800	9.800	9.800	9.800	9.800	9.800	9.800	9.800
5RK60RG-N □ 5GN □ K	9.7	11.7	16.2	19.4	24.3	29.2	32.4	36.5	43.8	52.6	58.4	66.0	79.2	95.0	106.0	132.0	158.0	177.0	200.0	200.0	200.0	200.0	200.0	200.0
	0.953	1.147	1.588	1.901	2.381	2.862	3.175	3.577	4.292	5.155	5.726	6.648	7.762	9.31	10.39	12.94	15.48	17.35	19.60	19.60	19.60	19.60	19.60	19.60
5RK90RG-U □ 5GU □ K	14.6	17.5	24.3	29.2	36.5	43.7	48.6	54.8	65.7	78.8	87.6	99.0	119.0	143.0	158.0	198.0	200.0	200.0	200.0	200.0	200.0	200.0	200.0	200.0
	1.431	1.715	2.381	2.862	3.577	4.675	4.763	5.370	6.439	7.722	8.585	9.702	11.66	14.01	15.48	19.40	19.60	19.60	19.60	19.60	19.60	19.60	19.60	19.60
5RK120RG-U □ 5GU □ K	18.7	22.5	31.2	37.4	46.8	56.1	62.4	70.2	84.2	101.0	112.0	126.0	152.0	182.0	200.0	200.0	200.0	200.0	200.0	200.0	200.0	200.0	200.0	200.0
	1.835	2.202	3.058	3.670	4.587	5.505	6.116	6.881	8.257	9.909	11.01	12.39	14.86	17.84	19.61	19.61	19.61	19.61	19.61	19.61	19.61	19.61	19.61	19.61
5RK180RG-U □ 5GU □ K	28.1	34.0	47.0	57.0	71.0	84.2	94.0	105.0	126.0	152.0	168.0	189.0	227.0	273.0	300.0	300.0	300.0	300.0	300.0	300.0	300.0	300.0	300.0	300.0
	2.756	3.334	4.609	5.590	6.963	8.257	9.218	10.30	12.39	14.91	16.51	18.58	22.29	26.75	29.42	29.42	29.42	29.42	29.42	29.42	29.42	29.42	29.42	29.42
6RK120RG-U □ 6GU □ K	17.8	21.3	29.6	35.5	44.4	53.3	53.3	69.7	80.0	96.1	96.1	121.0	146.0	174.0	193.0	241.0	289.0	362.0	400.0	400.0	400.0	400.0	400.0	400.0
	1.74	2.09	2.90	3.48	4.35	5.22	5.22	6.54	7.85	9.42	9.42	11.80	14.20	17.00	18.90	23.60	28.40	35.50	39.20	39.20	39.20	39.20	39.20	39.20
6RK140RG-U □ 6GU □ K	20.7	24.9	34.6	41.2	51.8	62.1	62.1	77.6	93.4	112.0	112.0	141.0	169.0	203.0	226.0	282.0	338.0	400.0	400.0	400.0	400.0	400.0	400.0	400.0
	2.03	2.44	3.39	4.06	5.08	6.09	6.09	7.60	9.15	11.00	11.00	13.80	16.60	19.90	22.10	27.60	33.10	39.20	39.20	39.20	39.20	39.20	39.20	39.20
6RK180RG-U □ 6GU □ K	20.7	24.9	34.6	41.2	51.8	62.1	62.1	77.6	93.4	112.0	112.0	141.0	169.0	203.0	226.0	282.0	338.0	400.0	400.0	400.0	400.0	400.0	400.0	400.0
	2.03	2.44	3.39	4.06	5.08	6.09	6.09	7.60	9.15	11.00	11.00	13.80	16.60	19.90	22.10	27.60	33.10	39.20	39.20	39.20	39.20	39.20	39.20	39.20
6RK200RG-U □ 6GU □ K	20.7	24.9	34.6	41.2	51.8	62.1	62.1	77.6	93.4	112.0	112.0	141.0	203.0	226.0	282.0	338.0	400.0	400.0	400.0	400.0	400.0	400.0	400.0	400.0
	2.03	2.44	3.39	4.06	5.08	6.09	6.09	7.60	9.15	11.00	11.00	13.80	16.60	19.90	22.10	27.60	33.10	39.20	39.20	39.20	39.20	39.20	39.20	39.20

刹车调速电机 Brake Speed Adjustable Motor



安装支架座

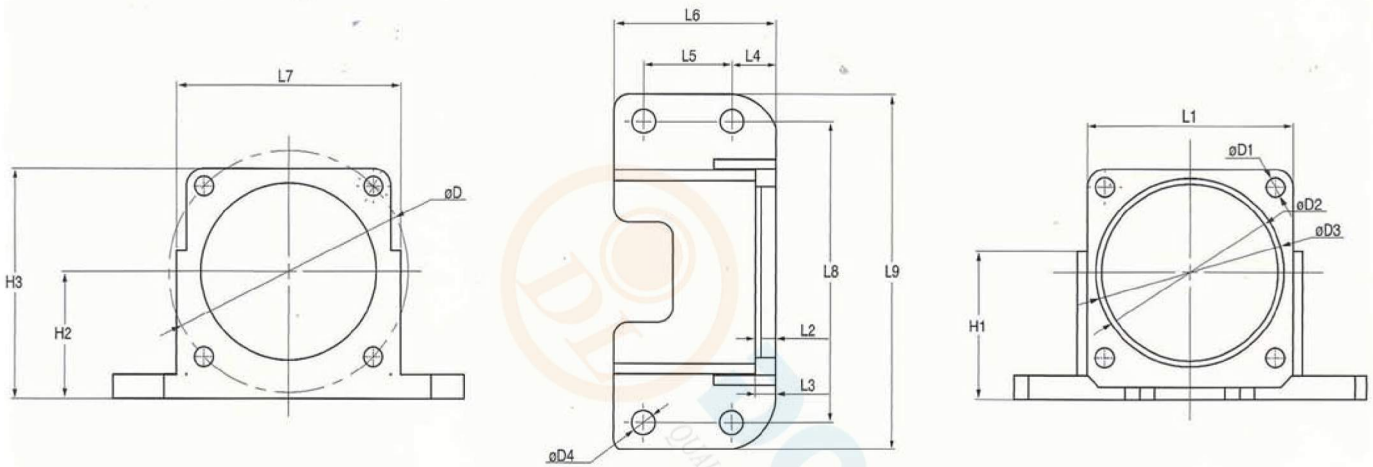

尺寸/型号	D1	D2	D3	D4	D	L1	L2	L3	L4	L5	L6	L7	L8	L9	H	H1	H2	H3
DPG3M5	6.50	64	60	8	82	70	7	2	15	30	55	76.60	102	120	8	50	43	78
DPG4M5	5.50	73	69	10	94	80	7	2	14	35	60	88	102	120	10	58	48.50	89
DPG5M5	7	83	73	7	104	90	7	2	10	40	80	100	115	131	8	52.40	51	96
DPG6M5	8.50	95	92	10	120	104	10	2	16	50	75	124	143	159	10.50	76.50	73	125

塑料接线盒(适用70、80、90、100电机)

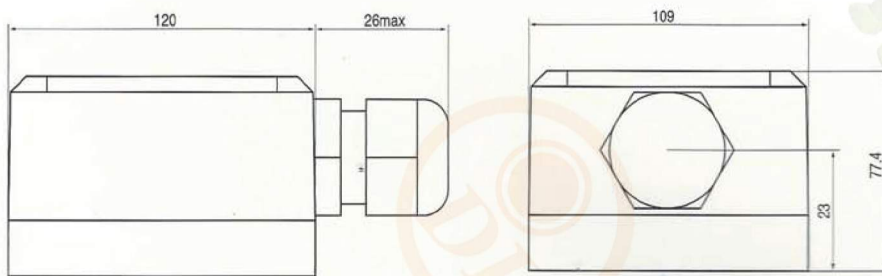

铝制接线盒(适用90、100电机)

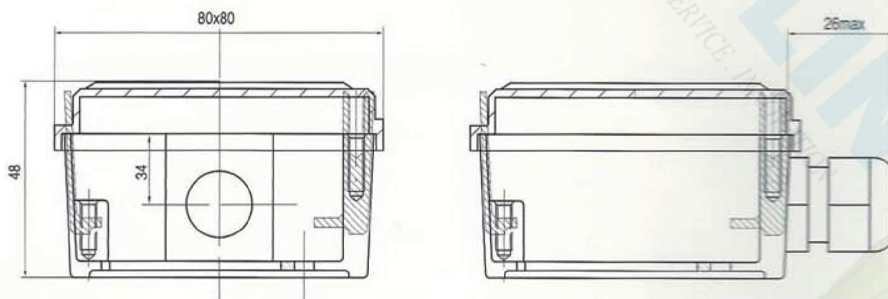

接线图 Wiring Diagram

電機接線圖 Wiring Diagram of Motor

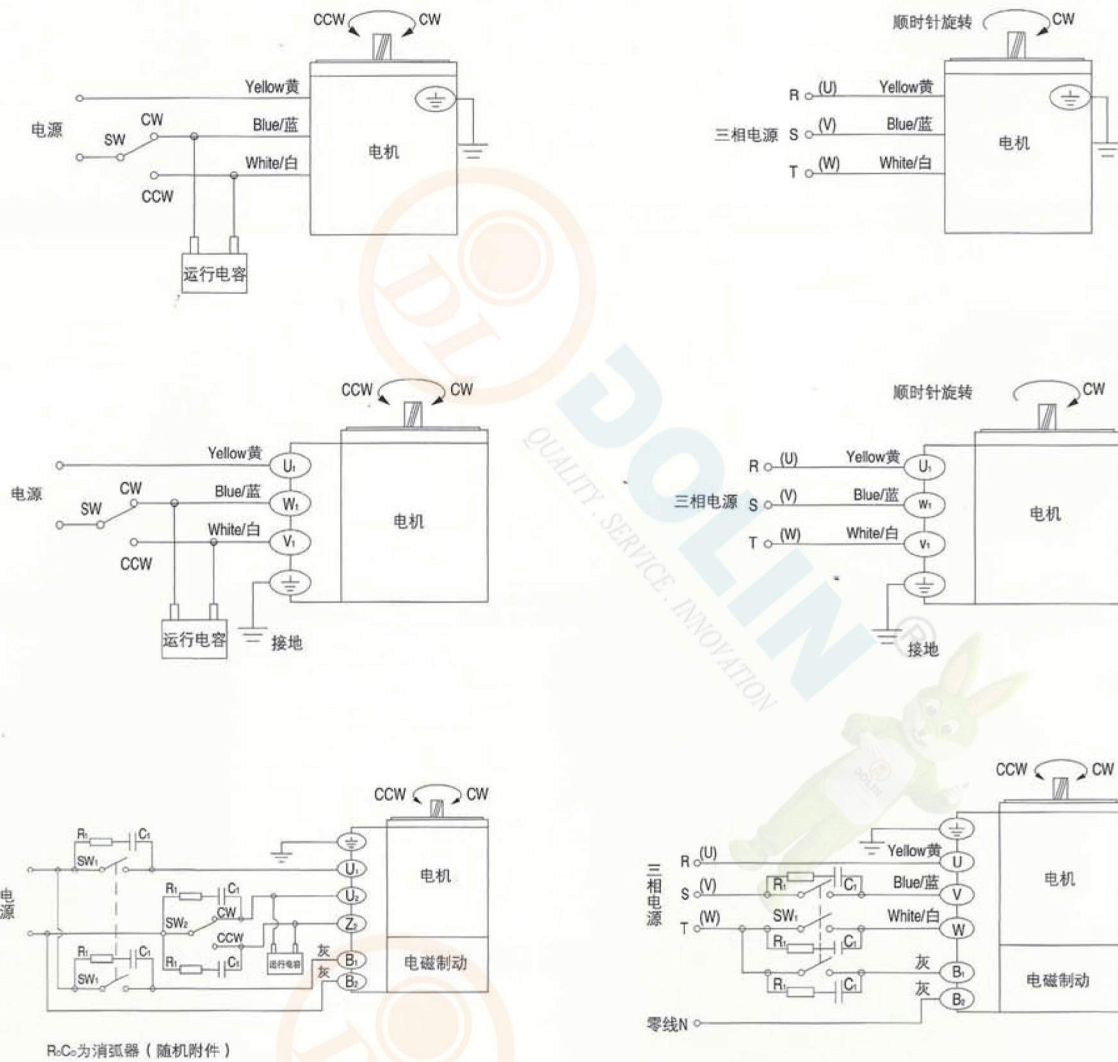

电容器 Capacitor

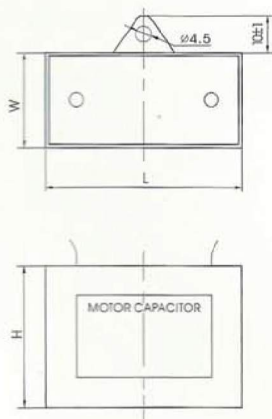

电容容量 Capacity μF 允许偏差 $\pm 5\%$	耐压 Voltage V	长 L ± 1 mm	宽 W ± 1 mm	高 H ± 1 mm	类型 Type
1.5	500	38	14	28	引线型
2	500	38	15	28	
2.5	500	38	18	29	
3	500	47	18	32	
3.5	500	49	21	29	
5	500	47	23	36	
6	500	47	23	36	
6.5	500	47	23	36	
8	500	47	26	39	
10	450	58	23	39	
12	500	58	25	45	
18	250	58	23	39	
30	450	68	32	56	

控制器型号说明 Description of Governor Model

U

调速器种类
Speed Controller Type

U: 组合型
U: Combination
S: 分离型
S: Separation

S

调速器功能
Speed Controller Function

S: 速度控制器
S: Speed Governor

11

电压
Voltage

11: 单相110V50Hz
11: Single Phase 110V50Hz
22: 单相220V50Hz
22: Single Phase 220V50Hz
33: 数字显示器
33: Digital Display

A

电容安装方式
Capacitor Mounting Type

A: 内置式电容器
A: Built-in Capacitor
B: 外置式电容器
B: External Capacitor

组合型 Combination US11、US22 正、反转变速 Clockwise and Anti-clockwise Speed Change

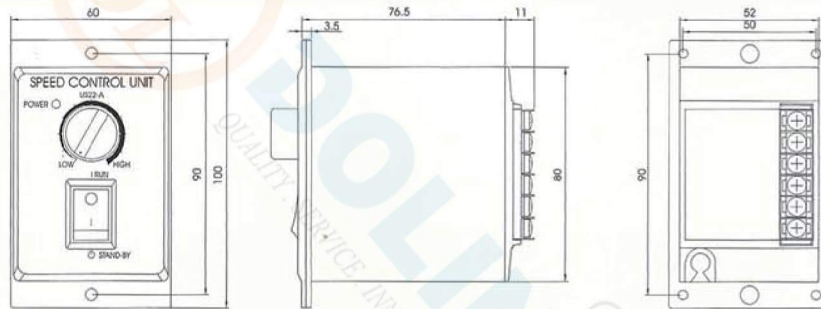

分离型 Separation SS11、SS22 正、反转变速 Clockwise and Anti-clockwise Speed Change

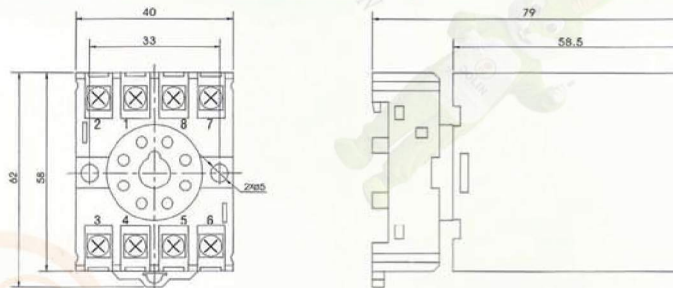





调速器特性表 List of Speed Governor Characteristics

参数Parameter 型号Model	电压(V) Voltage(V)	频率(Hz) Voltage(Hz)	最大电流(A) Peak Current(A)	电机功率(W) Motor Power(W)	速度范围(r/min) Speed Range(r/min)	速度变速器 Speed Changer	速度应答器 Speed Responder	速度安定性 Speed Stability	工作环境温度 Working Ambient Temperature
US11	110V±10%	50/60	5	6~140	90/1350	3%	(0.5)	优 Excellent	-10℃ ~ +50℃
US22	220V±10%				90/1650				
SS11	110V±10%	50/60	5	6~140	90/1350	3%	(0.5)	优 Excellent	-10℃ ~ +50℃
SS22	220V±10%				90/1650				
SS33	110V±10%	50/60	5	6~140	90/1350	3%	(0.5)	优 Excellent	-10℃ ~ +50℃
	220V±10%				90/1650				

产品说明 Products Description

非標電機
Special Motor

应用行业 application industry	应用电机 Motor	特点说明 Main Feature
制冷设备 木工机械 塑料机械 包装机械 refrigeration plant carpenter machinery Plastic machinery Packaging machinery		承载扭矩大、直角输出 higher Load torque, Right angle output
家用电器 食品机械 电动玩具 Household appliances Electric toys Food machinery		齿轮强度高、轴承承受力大、立卧式安装、电机功率可增大 high strength gear, High-performance bearings, Vertical horizontal, installation, Motor power can be increased
拉丝机专用电机 Drawbench		中心轴输出、硬齿面齿轮 Center shaft output, Hardened gear
热收缩机 焊机 Heat shrink machine Welding machine		耐高温、长轴电机、高温轴承、散热效果好 stand fire, long shaft, high-temperature bearing, Good cooling effect

电机拥有强大的技术研发团队和大量高精度的生产测量设备，能够满足客户特定需求，设计开发各种齿轮减速电机（电机500W以下，齿轮2模数以下），也可帮助客户开发制造高精度齿轮零部件，拥有年产30万套减速电机生产能力。

motor has a strong technical development team and a large number of high-precision production and measurement equipment, can meet customer specific Requirements, design and development of various gear motor (motor below 500W, gear 2 modulus below), also can help Customer development and manufacture of high precision gear parts, with an annual output of 300000 sets of motor production capacity.



台灣東菱集團公司

TAIWAN DONG LING M&E TECHNOLOGY MANUFACTURE CO.,LTD

台灣總公司
東菱精密減速機有限公司
 地址：台灣省台中市豐原區鑣村路605巷25號
 TAX: 61900138
 TEL: +886-4-25381758 25365291
 FAX: +886-4-25367525
 Sky: chen0302
 Email: sales@dolin-tech.com
 Website: www.dolin-tech.com

TAIWAN HEADQUARTERS
Dong Ling M&E Technology Manufacture Co.Ltd
 No 25, Lane 605, Liancun Rd, Fongyuan District,
 Taichung City 420, Taiwan
 TAX: 61900138
 TEL: +886-4-25381758 25365291
 FAX: +886-4-25367525
 Sky: chen0302
 Email: sales@dolin-tech.com
 Website: www.dolin-tech.com

越南分公司
越南東菱責任有限公司
平陽分公司
 地址：平陽省，順安鎮，順交坊，平順2，T15/2A
 TAX: 3702238714
 TEL: +84-274-3775395
 FAX: +84-274-3775394
 Sky: dolinsales10
 Email: dolinsales01@gmail.com
 Website: www.dolin.org.vn - www.dongling.com.vn

VIET NAM BRANCH COMPANY
Cong Ty TNHH MTV Thuong Mai Dich Vu Dong Ling
 Address: T15/2A, Binh Thuan 2 Quarter, Thuan Giao Ward, Thuan An Town,
 Binh Duong Province, Viet Nam.
 TAX: 3702238714
 TEL: +84-274-3775395
 FAX: +84-274-3775394
 Sky: dolinsales10
 Email: dolinsales01@gmail.com
 Website: www.dolin.org.vn - www.dongling.com.vn

河內分公司
 地址：河內市 龍邊郡 銅座區，蟬蟬街675號
 TAX: 3702238714
 TEL: +84-912.644.326
 Sky: 0918770248
 Email: dolinsales09@gmail.com
 Website: www.dolin.org.vn - www.dongling.com.vn

Ha Noi Representative Office
 Address: 675 Bat Khoi Street, Cu Khoi Ward, Long Bien District,
 Ha Noi, Viet Nam.
 TAX: 3702238714
 TEL: +84-912.644.326
 Sky: 0918770248
 Email: dolinsales09@gmail.com
 Website: www.dolin.org.vn - www.dongling.com.vn